

NOTES:

- 1.) ALL STL. MEMBERS COATED W/ ZINC RICH EPOXY THEN FINISHED W/ POLYESTER POWDER COATING.
- 2.) 1/2" X 2 1/2" NYLON GLIDES & 1/2" X 5 1/2" EXPANSION ANCHOR BOLTS PROVIDED.

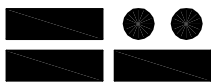

DuMor, inc.

P.O. Box 142 Mifflintown, PA 17059-0142

SCALE :	NONE
DATE DRAWN :	12/12/96
DRAWN BY :	AH
DATE REV. :	8/30/01
REV. BY :	JSB

TITLE :	TABLE		
REV.	DRAWING NUMBER	101-30	SHEET
E			1 OF 2

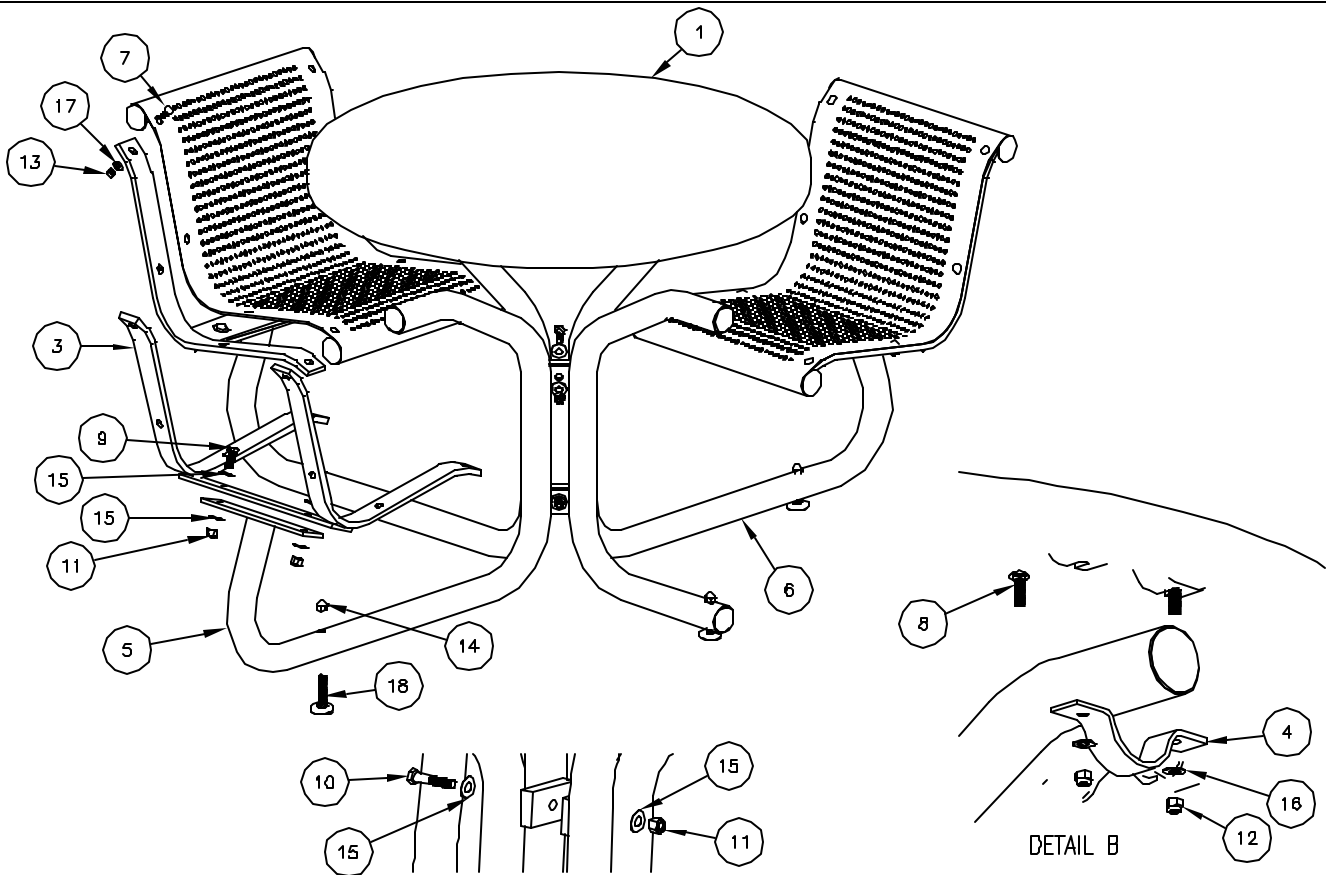

NOTES:

- 1.) DURING ASSEMBLY PROCEDURE;
DO NOT COMPLETELY TIGHTEN HARDWARE.
- 2.) THE ACTUAL PARTS WILL NOT BE NUMBERED;
NUMBERS ONLY APPLY TO DRAWING.

STEP 1:

- USE 1 - PC. SUPPORT FRAME/ 2 SEAT { 6 }
 1 - PC. SUPPORT FRAME/ 1 SEAT { 5 }
 2 - PCS. 1/2" X 2 1/2" SS. HEX HD. CAP SCR. { 10 }
 2 - PCS. 1/2" SS. NYLON LOCKNUT { 11 }
 4 - PCS. 1/2" SS. FLAT WASHER { 15 }
 4 - PCS. 1/2" SS. ACORN NUT { 14 }
 4 - PCS. 1/2" X 2 1/2" GLIDE { 18 }
- BOLT SUPPORT FRAMES/ 2 SEAT AND 1 SEAT { 5 & 6 } TOGETHER USING HARDWARE { 10, 11, & 15 }, ATTACH 1/2" X 2 1/2" GLIDE { 18 } USING HARDWARE { 14 }, TIGHTEN TO SNUG FIT. REPEAT UNTIL ALL GUIDES ARE ATTACHED.

STEP 2:

- USE 3 - PCS. ALL STL. SEAT FRAME { 3 }
 6 - PCS. 1/2" X 1 1/2" HEX HD. CAP SCR. { 9 }
 6 - PCS. 1/2" SS. NYLON LOCKNUT { 11 }
 12 - PCS. 1/2" SS. FLAT WASHER { 15 }
- ATTACH ALL STL. SEAT FRAME { 3 } TO STEP 1 ASSEMBLY USING HARDWARE { 9, 11, & 15 }. TIGHTEN TO SNUG FIT. REPEAT UNTIL ALL SEAT FRAMES ARE ATTACHED.

STEP 3:

- USE 3 - PCS. 14 GA. PERF. STL. SEAT { 2 }
 24 - PCS. 3/8" X 1" SS. CGE. BOLT { 7 }
 24 - PCS. 3/8" SS. HEX NUT. { 13 }
 24 - PCS. 3/8" SS. FLAT WASHER { 17 }
- ATTACH 14 GA. PERF. STL. SEAT { 2 } TO STEP 2 ASSEMBLY USING HARDWARE { 7, 13, & 17 }. TIGHTEN TO SNUG FIT. REPEAT UNTIL ALL 14 GA. PERF. SEATS ARE ATTACHED.

DETAIL A

DETAIL B

STEP 4:

- USE 1 - PC. TABLE TOP ASSY. { 1 }
 4 - PCS. 3/16" X 1 1/4" STL. CLAMP { 4 }
 8 - PCS. 5/16" X 1" SS. CGE. BOLT { 8 }
 8 - PCS. 5/16" SS. NYLON LOCKNUT { 12 }
 8 - PCS. 5/16" SS. FLAT WASHER { 16 }
- ATTACH TABLE TOP ASSY. AND 3/16" X 1 1/4" STL. CLAMP { 4 } TO STEP 3 ASSEMBLY USING HARDWARE { 8, 12, & 16 }. TIGHTEN TO SNUG FIT. REPEAT UNTIL CLAMPS ARE ATTACHED.

STEP 5:

UPON COMPLETION OF TABLE ASSEMBLY SQUARE ALL COMPONENTS THEN TIGHTEN ALL HARDWARE.

ITEM	QTY	PART NO	DESCRIPTION
1	1	0-101-00-D1	TABLE TOP ASSY.
2	3	0-101-00-02	14 GA PERF STL SEAT
3	3	0-101-00-03	ALL STL. SEAT FRAME
4	4	0-101-00-05	PIPE CLAMP (101)
5	1	0-101-00-11	SUPPORT FRAME / 1-SEAT
6	1	0-101-00-12	SUPPORT FRAME / 2-SEAT
7	24	1-11-028	3/8" X 1" SS CGE BOLT
8	8	1-11-032	5/16" X 1" SS CGE BOLT
9	6	1-12-004	1/2" X 1 1/2" SS HEX HD CAP SCR
10	2	1-12-076	1/2" X 2 1/2" SS HEX HD CAP SCR
11	8	1-20-015	1/2" SS NYLON LOCKNUT
12	8	1-20-016	5/16" SS NYLON LOCKNUT
13	24	1-21-007	3/8" SS HEX NUT
14	4	1-21-019	1/2" SS HEX ACORN NUT
15	16	1-22-015	1/2" SS FLAT WASHER
16	8	1-22-017	5/16" SS FLAT WASHER
17	24	1-22-024	3/8" SS FLAT WASHER
18	4	5-48-077	1/2" X 2 1/2" GLIDE

DuMor, inc.
 P.O. Box 142 Mifflintown, PA 17059-0142

SCALE : NONE
 DATE DRAWN : 12/12/96
 DRAWN BY : AH
 DATE REV. : 8/30/01
 REV. BY : JSB

TITLE : TABLE ASSEMBLY
 REV. E
 DRAWING NUMBER 101-30
 SHEET 2 OF 2