

WOOD OPTIONS

- CLEAR ALL HEART REDWOOD S4S EE
- 'C' & BTR. DOUGLAS FIR KD S4S EE
- CLEAR IPE S4S EE
- OTHER _____

NOTES

- 1.) ALL STL. MEMBERS COATED W/ ZINC RICH EPOXY THEN POLYESTER POWDER COATED.
- 2.) ALL WOOD MEMBERS TRTD. W/ CLEAR PRESERVATIVE.
- 3.) 1/2" X 3 3/4" EXPANSION ANCHOR BOLTS PROVIDED.

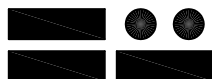

DuMor, inc.

P.O. Box 142 Mifflintown, PA 17059-0142

SCALE : NONE
 DATE DRAWN : 2/21/99
 DRAWN BY : JSB
 DATE REV. : 12/18/08
 REV. BY : ESS

TITLE :
 REV. D

BENCH

DRAWING NUMBER

121 SERIES

SHEET 1 OF 2

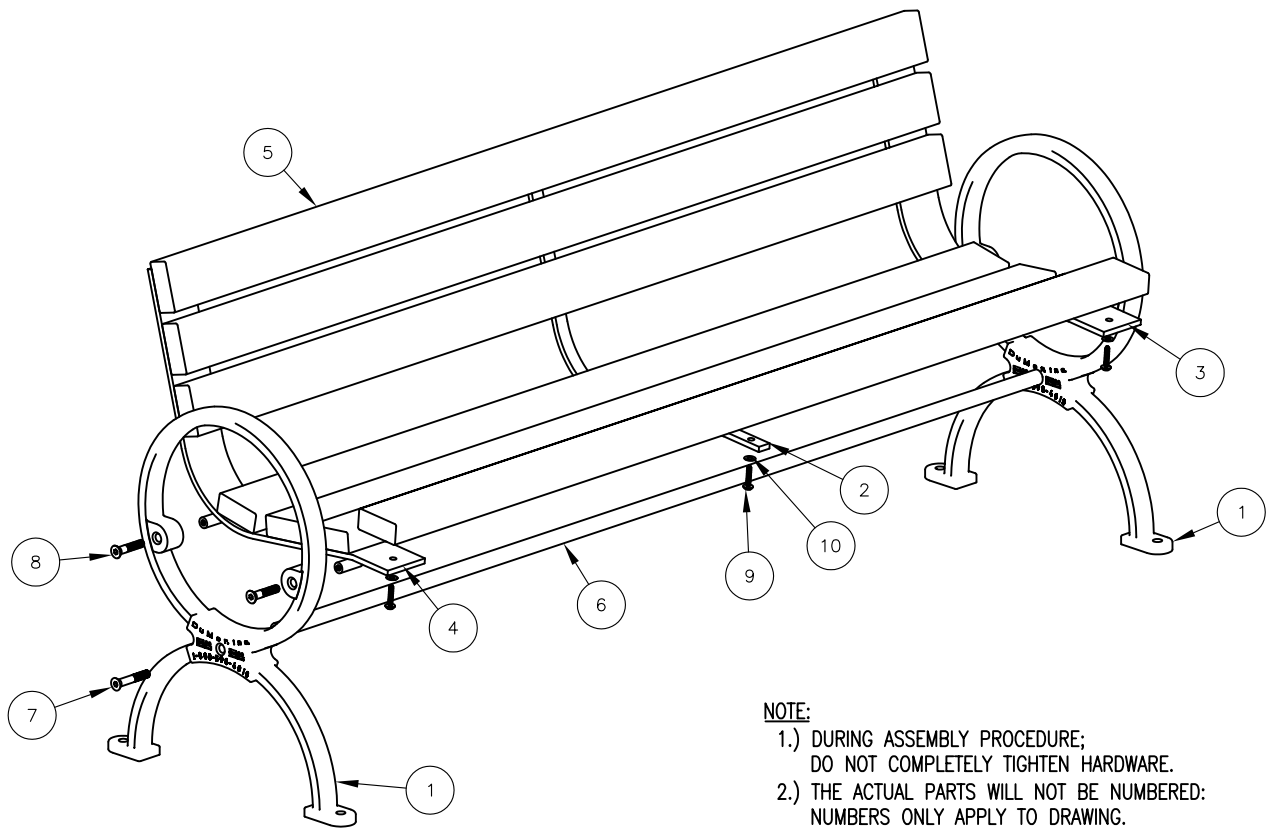

NOTE:

- 1.) DURING ASSEMBLY PROCEDURE;
DO NOT COMPLETELY TIGHTEN HARDWARE.
- 2.) THE ACTUAL PARTS WILL NOT BE NUMBERED:
NUMBERS ONLY APPLY TO DRAWING.

STEP 1:

USE 2 - PC. CAST IRON END SUPPORT (1)
 1 - PC. 71 3/4" PIPE BRACE (6)
 2 - PC. 1/2" X 3" SS. FLT. SKT. HD. CAP SCR. (7)
 ATTACH CAST IRON END BENCH SUPPORT (1) TO 71 3/4" PIPE BRACE (6) USING HARDWARE (7). TIGHTEN TO SNUG FIT

STEP 2:

USE 1 - PC. LEFT SUPPORT STRAP (3)
 1 - PC. RIGHT SUPPORT STRAP (4)
 4 - PCS. 1/2" X 2 1/2" FLT. SKT. HD. CAP SCR. (8)
 ATTACH LEFT SUPPORT STRAP (3) & RIGHT SUPPORT STRAP (4) TO STEP 1 ASSEMBLY USING HARDWARE (8). TIGHTEN TO SNUG FIT.

STEP 3:

USE 7 - PCS. 2" X 4" X 71" WOOD SLAT (5)
 14 - PCS. 5/16" X 1 1/2" SS. BTN. SKT. HD. LAG (9)
 14 - PCS. 5/16" SS. FLAT WASHER (10)
 ATTACH 2" X 4" X 71" WOOD SLATS USING HARDWARE (9 & 10). TIGHTEN TO SNUG FIT.

STEP 4:

USE 1 - PC. CENTER STRAP (2)
 7 - PCS. 5/16" X 1 1/2" SS. BTN. SKT. HD. LAG (9)
 7 - PCS. 5/16" SS. FLAT WASHER (10)
 ATTACH CENTER STRAP (2) TO STEP 3 ASSEMBLY USING HARDWARE (9 & 10). TIGHTEN TO SNUG FIT.

STEP 5:

UPON COMPLETION OF BENCH ASSEMBLY SQUARE ALL COMPONENTS THEN TIGHTEN ALL HARDWARE.

STEP 6:

MOUNT AND ANCHOR AS SPECIFIED.

ITEM	QTY	PART NO	DESCRIPTION
1	2	0-119-00-01	CAST IRON SUPPORT
2	1	0-121-00-05	CENTER CONTOUR STRAP
3	1	0-121-00L-02	LEFT SUPPORT STRAP
4	1	0-121-00R-02	RIGHT HAND SEAT SUPPORT STRAP
5	7	0-121-60-01	2" X 4" X 71" WOOD SLAT
6	1	0-57-60-04	71 3/4" PIPE BRACE
7	2	1-12-037	1/2" X 3" SS FLT SKT HD CAP SCR
8	4	1-12-065	1/2" X 2 1/2" FLT SKT HD CAP SCR
9	21	1-13-023	5/16" X 1 1/2" SS BTN SKT HD LAG
10	21	1-22-017	5/16" SS FLAT WASHER

DuMor, inc.
 P.O. Box 142 Mifflintown, PA 17059-0142

SCALE : NONE
 DATE DRAWN : 2/21/99
 DRAWN BY : JSB
 DATE REV. : 12/18/08
 REV. BY : ESS

TITLE : BENCH ASSEMBLY

REV. D

DRAWING NUMBER

121 SERIES

SHEET 2 OF 2