

CUSTOM LETTERING (37 SPACES) _____

NOTES

- 1.) ALL STL. MEMBERS COATED W/ ZINC RICH EPOXY THEN FINISHED W/ POLYESTER POWDER COATING.
- 2.) 1/2" X 3 3/4" EXPANSION ANCHOR BOLTS PROVIDED.
- 3.) CUSTOM LETTERING AVAILABLE FOR RECESSED SIDE PANELS (TOTAL OF 37 SPACES).

SLAT OPTIONS

- "CEDAR" RECYCLED PLASTIC
- "GREY" RECYCLED PLASTIC
- "GREEN" RECYCLED PLASTIC
- "REDWOOD" RECYCLED PLASTIC
- "WALNUT" RECYCLED PLASTIC
- OTHER _____



DuMor, inc.
P.O. Box 142 Mifflintown, PA 17059-0142

SCALE : NONE
DATE DRAWN : 7/30/01
DRAWN BY : AH
DATE REV. : 12/2/09
REV. BY : JSB

TITLE : BENCH
PATENT D467-101

REV.
D

DRAWING
NUMBER

143-40PL

SHEET
1 OF 2

NOTE:

- 1.) DURING ASSEMBLY PROCEDURE;
DO NOT COMPLETELY TIGHTEN HARDWARE.
- 2.) THE ACTUAL PARTS WILL NOT BE NUMBERED.
NUMBERS ONLY APPLY TO DRAWING.

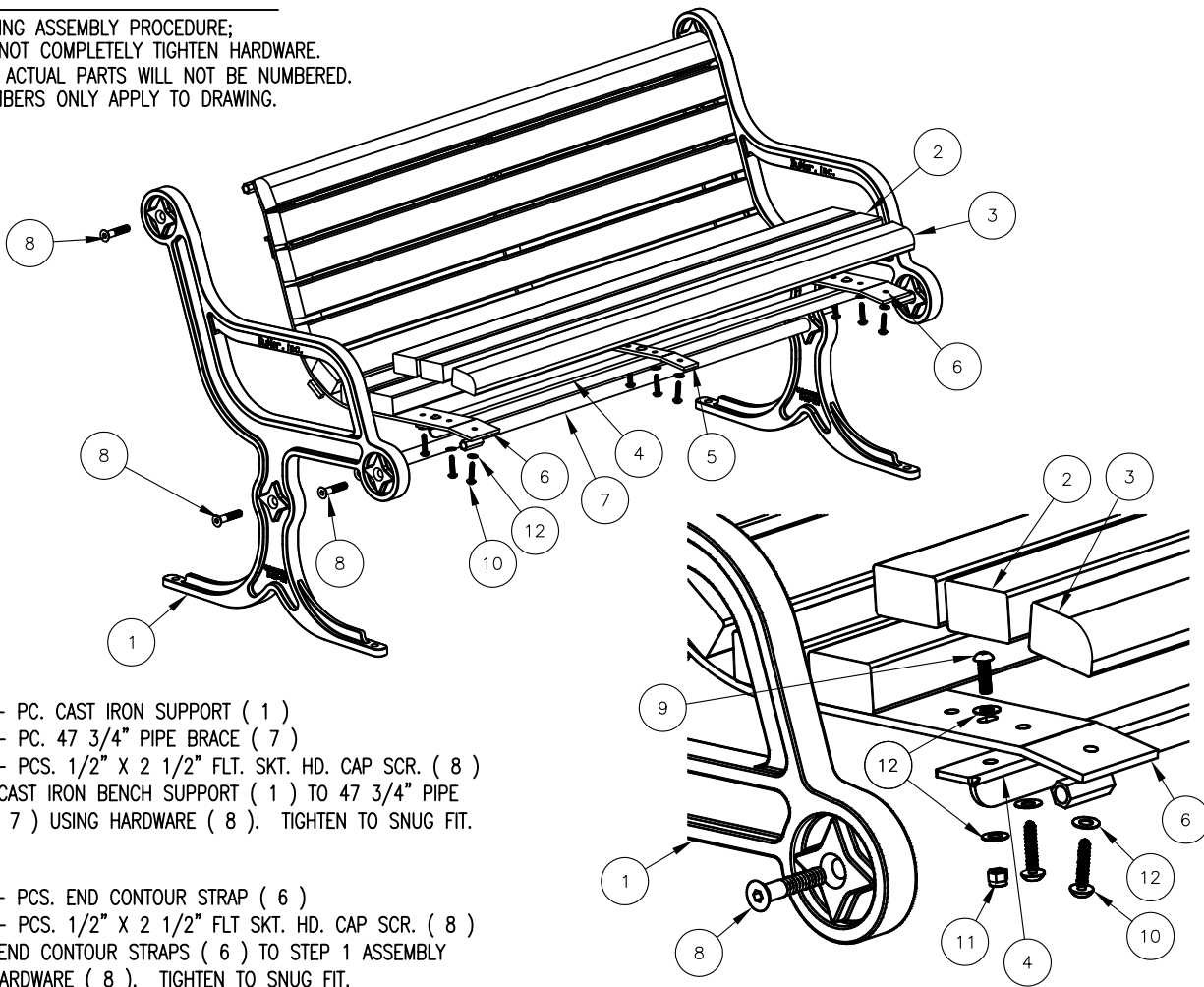

STEP 1:

- USE 2 - PC. CAST IRON SUPPORT (1)
 1 - PC. 47 3/4" PIPE BRACE (7)
 2 - PCS. 1/2" X 2 1/2" FLT. SKT. HD. CAP SCR. (8)
 ATTACH CAST IRON BENCH SUPPORT (1) TO 47 3/4" PIPE BRACE (7) USING HARDWARE (8). TIGHTEN TO SNUG FIT.

STEP 2:

- USE 2 - PCS. END CONTOUR STRAP (6)
 4 - PCS. 1/2" X 2 1/2" FLT SKT. HD. CAP SCR. (8)
 ATTACH END CONTOUR STRAPS (6) TO STEP 1 ASSEMBLY USING HARDWARE (8). TIGHTEN TO SNUG FIT.

STEP 3:

- USE 2 - PCS. 47" SEAT BRACE (4)
 4 - PCS. 5/16" X 1" SS. BTN SKT HD CAP SCR (9)
 4 - PCS. 5/16" SS. NYLON LOCKNUT (11)
 8 - PCS. 5/16" SS. FLAT WASHER (12)
 ATTACH 47" SEAT BRACE (4) TO STEP 2 ASSEMBLY USING HARDWARE (9, 11 & 12). TIGHTEN TO SNUG FIT.

STEP 4:

- USE 1 - PC. CENTER CONTOUR STRAP (5)
 2 - PCS. 5/16" X 1" SS. BTN SKT HD CAP SCR (9)
 2 - PCS. 5/16" SS. NYLON LOCKNUT (11)
 4 - PCS. 5/16" SS. FLAT WASHER (12)
 ATTACH CENTER CONTOUR STRAP (5) TO STEP 3 ASSEMBLY USING HARDWARE (9, 11 & 12). TIGHTEN TO SNUG FIT.

STEP 5:

- USE 9 - PCS. 2" X 3" X 47" PLASTIC INT'R SLAT (2)
 2 - PCS. 2" X 3" X 47" PLASTIC EDGE SLAT (3)
 33 - PCS. 5/16" X 1 1/2" SS. BTN. SKT. HD. LAG (10)
 33 - PCS. 5/16" SS. FLAT WASHER (12)
 ATTACH 2" X 3" X 47" PLASTIC SLATS (2 & 3) TO STEP 4 ASSEMBLY USING HARDWARE (10 & 12). TIGHTEN TO SNUG FIT.
 REPEAT UNTIL ALL SLATS ARE ATTACHED.

DETAIL A

STEP 6:

UPON COMPLETION OF BENCH ASSEMBLY SQUARE ALL COMPONENTS THEN TIGHTEN ALL HARDWARE.

STEP 7:

MOUNT AND ANCHOR AS SPECIFIED.

| ITEM | QTY | PART NO | DESCRIPTION |
|------|-----|---------------|-------------------------------------|
| 1 | 2 | 0-140-00-01 | CAST IRON BENCH SUPPORT |
| 2 | 9 | 0-143-40PL-01 | 2" X 3" X 47" INTERIOR PLASTIC SLAT |
| 3 | 2 | 0-143-40PL-02 | 2" X 3" X 47" PLASTIC EDGE SLAT |
| 4 | 2 | 0-16-40-06 | 47" SEAT BRACE |
| 5 | 1 | 0-57-00-03 | CENTER CONTOUR STRAP |
| 6 | 2 | 0-57-00-05 | END CONTOUR STRAP |
| 7 | 1 | 0-57-40-04 | 47 3/4" PIPE BRACE |
| 8 | 6 | 1-12-065 | 1/2" X 2 1/2" FLT SKT HD CAP SCR |
| 9 | 6 | 1-12-116 | 5/16" X 1" SS BTN SKT HD CAP SCR |
| 10 | 33 | 1-13-023 | 5/16" X 1 1/2" SS BTN SKT HD LAG |
| 11 | 6 | 1-20-016 | 5/16" SS NYLON LOCKNUT |
| 12 | 45 | 1-22-017 | 5/16" SS FLAT WASHER |

DuMor, inc.
 P.O. Box 142 Mifflintown, PA 17059-0142

SCALE : NONE
 DATE DRAWN : 7/30/01
 DRAWN BY : AWH
 DATE REV. : 12/2/09
 REV. BY : JSB

TITLE : BENCH ASSEMBLY
 PATENT D467-101

| | | |
|--------|-------------------------|--------------|
| REV. D | DRAWING NUMBER 143-40PL | SHEET 2 OF 2 |
|--------|-------------------------|--------------|