

CUSTOM LETTERING ( 37 SPACES ) \_\_\_\_\_

**NOTES**

- 1.) ALL STL. MEMBERS COATED W/ ZINC RICH EPOXY THEN FINISHED W/ POLYESTER POWDER COATING.
- 2.) 1/2" X 3 3/4" EXPANSION ANCHOR BOLTS PROVIDED.
- 3.) CUSTOM LETTERING AVAILABLE FOR RECESSED SIDE PANELS ( TOTAL OF 37 SPACES ).

**SLAT OPTIONS**

- "CEDAR" RECYCLED PLASTIC
- "GREY" RECYCLED PLASTIC
- "GREEN" RECYCLED PLASTIC
- "REDWOOD" RECYCLED PLASTIC
- "WALNUT" RECYCLED PLASTIC
- OTHER \_\_\_\_\_

**DuMor, inc.**  
P.O. Box 142 Mifflintown, PA 17059-0142

SCALE : NONE  
DATE DRAWN : 7/10/01  
DRAWN BY : AH  
DATE REV. : 12/2/09  
REV. BY : JSB

TITLE : BENCH  
PATENT D467-101

REV. D	DRAWING NUMBER 143-60PL	SHEET 1 OF 2
--------	-------------------------	--------------

**NOTE:**

- 1.) DURING ASSEMBLY PROCEDURE;  
DO NOT COMPLETELY TIGHTEN HARDWARE.
- 2.) THE ACTUAL PARTS WILL NOT BE NUMBERED.  
NUMBERS ONLY APPLY TO DRAWING.

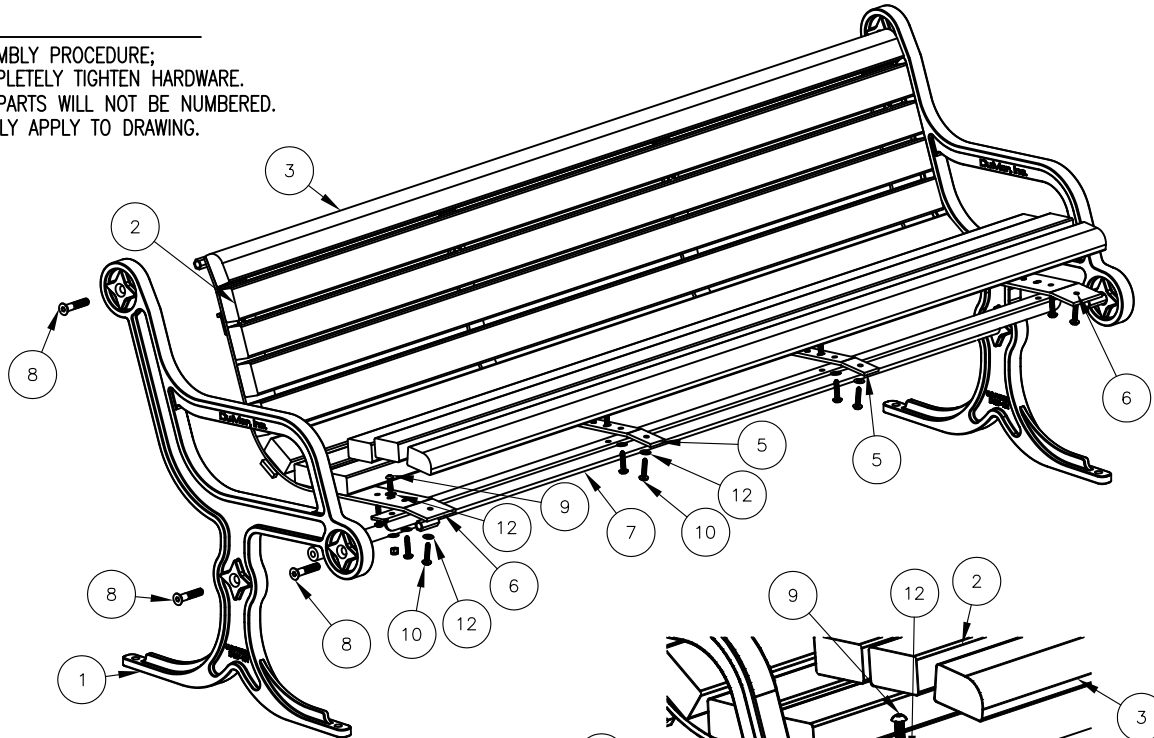

**STEP 1:**

- USE 2 - PC. CAST IRON SUPPORT ( 1 )  
 1 - PC. 71 3/4" PIPE BRACE ( 7 )  
 2 - PCS. 1/2" X 2 1/2" FLT. SKT. HD. CAP SCR. ( 8 )  
 ATTACH CAST IRON BENCH SUPPORT ( 1 ) TO 71 3/4" PIPE BRACE ( 7 ) USING HARDWARE ( 8 ). TIGHTEN TO SNUG FIT.

**STEP 2:**

- USE 2 - PCS. END CONTOUR STRAP ( 6 )  
 4 - PCS. 1/2" X 2 1/2" FLT SKT. HD. CAP SCR. ( 8 )  
 ATTACH END CONTOUR STRAPS ( 6 ) TO STEP 1 ASSEMBLY USING HARDWARE ( 8 ). TIGHTEN TO SNUG FIT.

**STEP 3:**

- USE 2 - PCS. 71" SEAT BRACE ( 4 )  
 4 - PCS. 5/16" X 1" SS. BTN SKT HD CAP SCR ( 9 )  
 4 - PCS. 5/16" SS. NYLON LOCKNUT ( 11 )  
 8 - PCS. 5/16" SS. FLAT WASHER ( 12 )  
 ATTACH 71" SEAT BRACE ( 4 ) TO STEP 2 ASSEMBLY USING HARDWARE ( 9, 11 & 12 ). TIGHTEN TO SNUG FIT.

**STEP 4:**

- USE 2 - PCS. CENTER CONTOUR STRAP ( 5 )  
 4 - PCS. 5/16" X 1" SS. BTN SKT HD CAP SCR ( 9 )  
 4 - PCS. 5/16" SS. NYLON LOCKNUT ( 11 )  
 8 - PCS. 5/16" SS. FLAT WASHER ( 12 )  
 ATTACH CENTER CONTOUR STRAP ( 5 ) TO STEP 3 ASSEMBLY USING HARDWARE ( 9, 11 & 12 ). TIGHTEN TO SNUG FIT.

**STEP 5:**

- USE 9 - PCS. 2" X 3" X 71" PLASTIC INT'R SLAT ( 2 )  
 2 - PCS. 2" X 3" X 71" PLASTIC EDGE SLAT ( 3 )  
 44 - PCS. 5/16" X 1 1/2" SS. BTN. SKT. HD. LAG ( 10 )  
 44 - PCS. 5/16" SS. FLAT WASHER ( 12 )  
 ATTACH 2" X 3" X 71" PLASTIC SLATS ( 2 & 3 ) TO STEP 4 ASSEMBLY USING HARDWARE ( 10 & 12 ). TIGHTEN TO SNUG FIT.  
 REPEAT UNTIL ALL SLATS ARE ATTACHED.

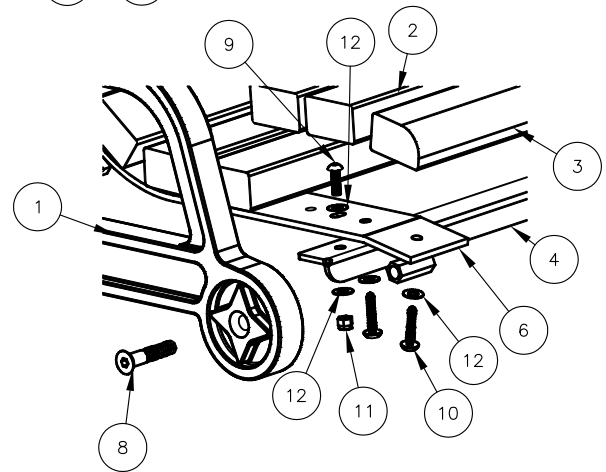

**DETAIL A**

**STEP 6:**

UPON COMPLETION OF BENCH ASSEMBLY SQUARE ALL COMPONENTS THEN TIGHTEN ALL HARDWARE.

**STEP 7:**

MOUNT AND ANCHOR AS SPECIFIED.

ITEM	QTY	PART NO	DESCRIPTION
1	2	0-140-00-01	CAST IRON BENCH SUPPORT
2	9	0-143-60PL-01	2" X 3" X 71" PLASTIC INT'R SLAT
3	2	0-143-60PL-02	2" X 3" X 71" PLASTIC EDGE SLATS
4	2	0-16-60-06	71" SEAT BRACE
5	2	0-57-00-03	CENTER CONTOUR STRAP
6	2	0-57-00-05	END CONTOUR STRAP
7	1	0-57-60-04	71 3/4" PIPE BRACE
8	6	1-12-065	1/2" X 2 1/2" FLT SKT HD CAP SCR
9	8	1-12-116	5/16" X 1" SS BTN SKT HD CAP SCR
10	44	1-13-023	5/16" X 1 1/2" SS BTN SKT HD LAG
11	8	1-20-016	5/16" SS NYLON LOCKNUT
12	60	1-22-017	5/16" SS FLAT WASHER

**DuMor, inc.**  
 P.O. Box 142 Mifflintown, PA 17059-0142

SCALE : NONE  
 DATE DRAWN : 7/10/01  
 DRAWN BY : AWH  
 DATE REV. : 12/2/09  
 REV. BY : JSB

TITLE : BENCH ASSEMBLY  
 PATENT D467-101

REV. D	DRAWING NUMBER 143-60PL	SHEET 2 OF 2
--------	-------------------------	--------------