

ANCHORING DETAIL

FINISH OPTIONS:

- ALL STL. MEMBERS COATED W/ ZINC RICH EPOXY THEN FINISHED W/ POLYESTER POWDER COATING.
- HOT DIP GALV. AFTER FABRICATION.

NOTE:

- 1.) 1/4" X 1 1/2" HAMMERSET ANCHORS AND 1 1/4" PIPE CLAMPS PROVIDED ( 4 - PCS )
- 2.) ALL DOUGLAS FIR WOOD MEMBER TREATED WITH CLEAR PRESERVATIVE.

WOOD OPTIONS

- #1 SOUTHERN YELLOW PINE S4S EE
- 'C' & BTR. DOUGLAS FIR KD S4S EE
- OTHER \_\_\_\_\_

**DuMor, inc.**  
P.O. Box 142 Mifflintown, PA 17059-0142

SCALE : NONE  
DATE DRAWN : 3/22/94  
DRAWN BY : CDC  
DATE REV. : 11/12/08  
REV. BY : ESS

TITLE : PICNIC TABLE

REV. G

DRAWING NUMBER 71-68-1

SHEET 1 OF 2

**NOTE:**

- 1.) DURING ASSEMBLY PROCEDURE;  
DO NOT COMPLETELY TIGHTEN HARDWARE.
- 2.) THE ACTUAL PARTS WILL NOT BE NUMBERED;  
NUMBERS ONLY APPLY TO DRAWING.
- 3.) SEE SPEC. SHEET 1 FOR MOUNTING DETAILS

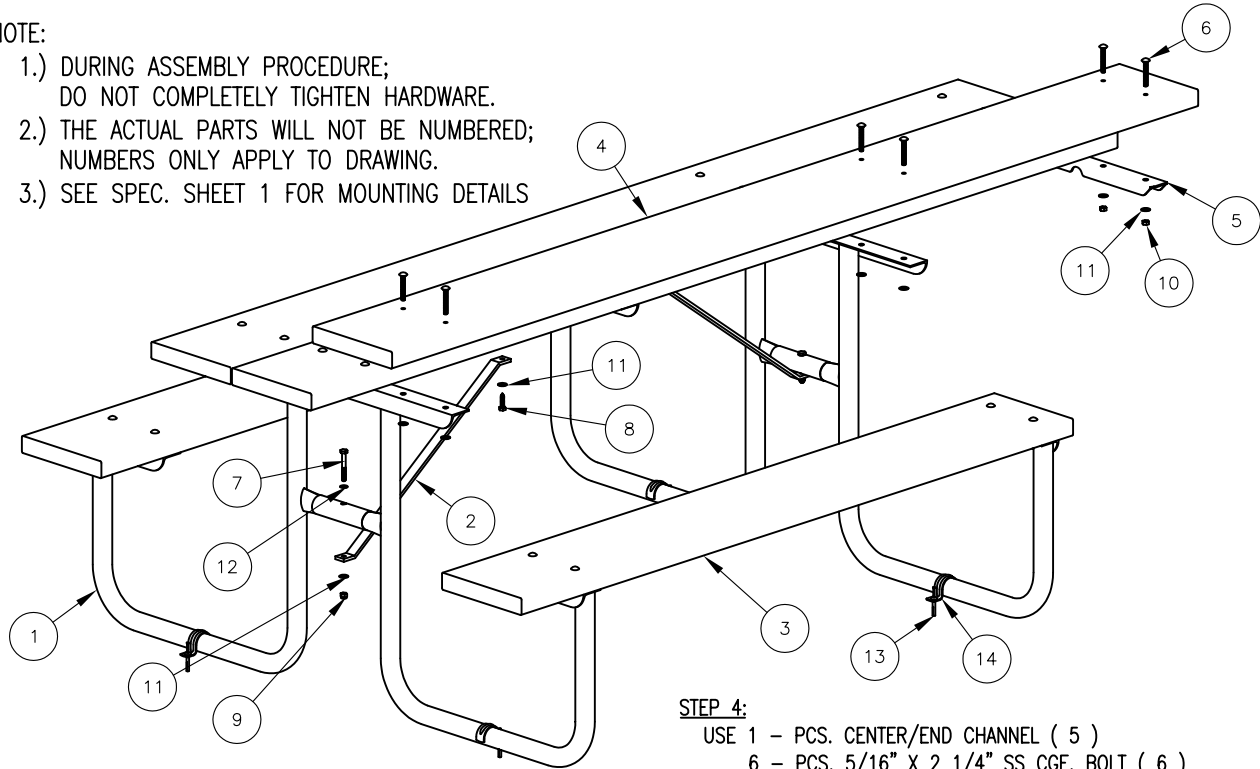

**STEP 1:**

- USE 3 - PCS. 2" X 10" X 95" WOOD PLANKS ( 4 )  
 2 - PCS. END SUPPORT FRAME ( 1 )  
 12 - PCS. 5/16" X 2 1/4" SS CGE. BOLT ( 6 )  
 12 - PCS. 5/16" SS HEX NUT ( 10 )  
 12 - PCS. 5/16" SS FLAT WASHER ( 11 )
- ATTACH 2" X 10" X 95" WOOD SLATS ( 4 ) TO END SUPPORT FRAME ( 1 ) USING HARDWARE ( 6, 10, & 11 ). TIGHTEN TO SNUG FIT.

**STEP 2:**

- USE 2 - PCS. 2" X 10" X 65" WOOD PLANKS ( 3 )  
 8 - PCS. 5/16" X 2 1/4" SS CGE. BOLT ( 6 )  
 8 - PCS. 5/16" SS HEX NUT ( 10 )  
 8 - PCS. 5/16" SS FLAT WASHER ( 11 )
- ATTACH 2" X 10" X 65" WOOD SLATS ( 3 ) TO STEP 1 ASSEMBLY USING HARDWARE ( 6, 10, & 11 ). TIGHTEN TO SNUG FIT.

**STEP 3:**

- USE 2 - PCS. DIAGONAL BRACE ( 2 )  
 2 - PCS. 5/16" X 2 1/2" SS HEX HD CAP SCR. ( 7 )  
 2 - PCS. 5/16" X 1 1/4" SS HEX HD LAG SCR. ( 8 )  
 2 - PCS. 5/16" SS NYLON LOCK NUT ( 9 )  
 4 - PCS. 5/16" SS FLAT WASHER ( 11 )  
 2 - PCS. 3/8" ID X 5/8" OD RUBBER WASHER ( 12 )
- SQUARE STEP 2 ASSEMBLY THEN ATTACH DIAGONAL BRACE ( 2 ) TO STEP 2 ASSEMBLY USING HARDWARE ( 7, 8, 9, 11, & 12 ). NO PILOT HOLES FOR 5/16" X 1 1/4" SS HEX HD LAG SCR. ( 8 ).

**STEP 4:**

- USE 1 - PCS. CENTER/END CHANNEL ( 5 )  
 6 - PCS. 5/16" X 2 1/4" SS CGE. BOLT ( 6 )  
 6 - PCS. 5/16" SS HEX NUT ( 10 )  
 6 - PCS. 5/16" SS FLAT WASHER ( 11 )
- ATTACH CENTER/END CHANNEL ( 5 ) TO STEP 3 TABLE TOP ASSEMBLY USING HARDWARE ( 6, 10, & 11 ). TIGHTEN TO SNUG FIT.

**STEP 5:**

UPON COMPLETION OF TABLE ASSEMBLY SQUARE ALL COMPONENTS THEN TIGHTEN ALL HARDWARE.

**STEP 6:**

- 4 - PCS. 1/4" X 1 1/2" HAMMERSET ANCHORS ( 13 )  
 4 - PCS. 1 1/4" RIGID PIPE CLAMP ( 14 )
- PLACE TABLE IN SITE LOCATION DESIRED. PLACE 1 1/4" RIGID PIPE CLAMP IN CENTER OF TABLE LEGS. MARK HOLES AND MOVE 1 1/4" RIGID PIPE CLAMPS. DRILL 1/4" DIA HOLE IN CONCRETE AT MARKED HOLE LOCATIONS APPROX. 2" DEEP. BLOW OUT DUST IN DRILLED HOLES. PLACE 1 1/4" RIGID PIPE CLAMPS IN OVER TABLE LEGS AND IN LINE WITH DRILLED HOLES. PLACE 1/4" X 1 1/2" HAMMERSET ANCHORS IN HOLES AND DRIVE IN WITH HAMMER.

ITEM	QTY	PART NO	DESCRIPTION
1	2	0-71-00-02	END SUPPORT FRAME
2	2	0-71-00-03	DIAGONAL BRACE
3	2	0-71-68-1-01	2" X 10" X 65" SLAT, WOOD
4	3	0-71-68-1-02	2" X 10" X 95" WOOD SLAT
5	1	0-77-00-03	CENTER/END CHANNEL
6	26	1-11-062	5/16" X 2 1/4" SS CGE BOLT
7	2	1-12-079	5/16" X 2 1/2" SS HEX HD CAP SCR
8	2	1-13-001	5/16" X 1 1/4" SS HEX HD LAG SCR
9	2	1-20-016	5/16" SS NYLON LOCKNUT
10	26	1-21-015	5/16" SS HEX NUT
11	30	1-22-017	5/16" SS FLAT WASHER
12	2	1-22-018	3/8" ID X 5/8" OD RUBBER WASHER
13	4	1-17-021	1/4" X 1 1/2" SS HAMMERSET ANCHOR
14	4	5-48-491	1 1/4" RIGID PIPE CLAMP, 3/8" DIA HOLE, PLTD

**DuMor, inc.**  
 P.O. Box 142 Mifflintown, PA 17059-0142

SCALE : NONE  
 DATE DRAWN : 3/22/94  
 DRAWN BY : CDC  
 DATE REV. : 11/12/08  
 REV. BY : ESS

TITLE : PICNIC TABLE

REV. G	DRAWING NUMBER 71-68-1	SHEET 2 OF 2
--------	------------------------	--------------