

LENGTH OPTIONS

- 6' TABLE
- 8' TABLE



DuMor, inc.

P.O. Box 142 Mifflintown, PA 17059-0142

SCALE : NONE

DATE DRAWN : 3/22/94

DRAWN BY : AH

DATE REV. : 10/11/16

REV. BY : AWH

TITLE :

PICNIC TABLE

REV. G

DRAWING NUMBER

72 SERIES A

SHEET 1 OF 3

NOTE:

- 1.) DURING ASSEMBLY PROCEDURE:
DO NOT COMPLETELY TIGHTEN HARDWARE
- 2.) THE ACTUAL PARTS WILL NOT BE NUMBERED:
NUMBERS ONLY APPLY TO DRAWING.

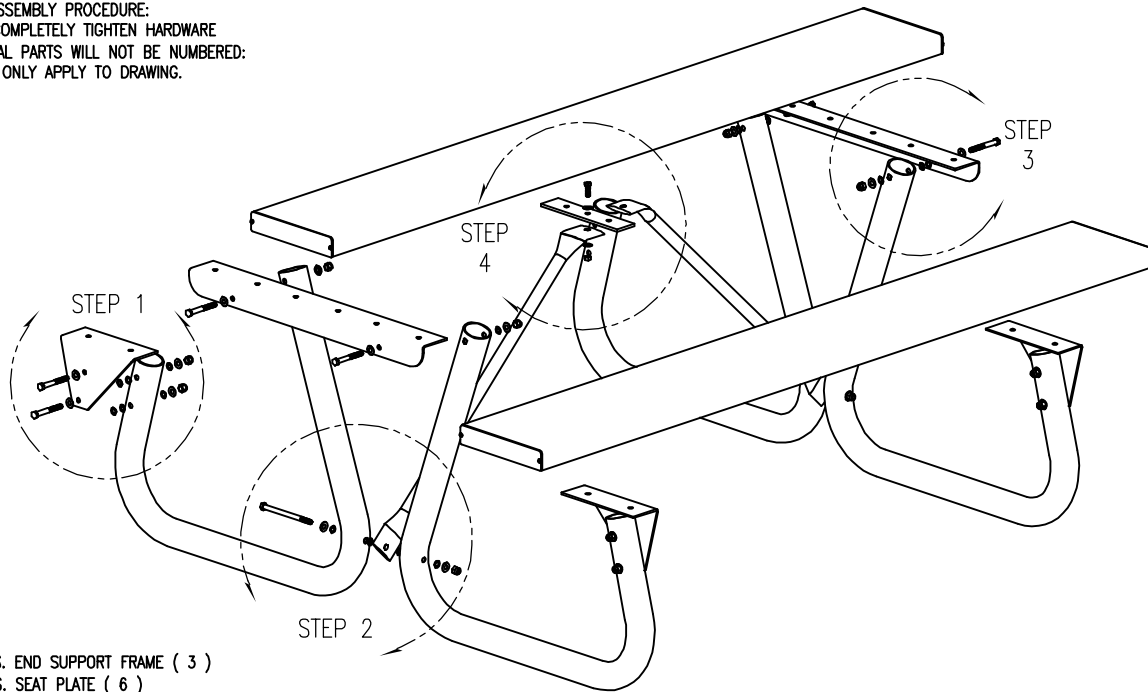

STEP 1:

- USE 4 - PCS. END SUPPORT FRAME (3)
 4 - PCS. SEAT PLATE (6)
 8 - PCS. 3/8" X 3" SS. HEX HD. CAP SCR. (7)
 8 - PCS. 3/8" SS. NYLON LOCK NUT (10)
 24 - PCS. 3/8" ID X 5/8" OD RUBBER WASHER (13)
 16 - PCS. 3/8" S.STL WASHER (14)
 ATTACH SEAT PLATE (6) TO END SUPPORT FRAME (3) USING HARDWARE (7, 10, 13 & 14). TIGHTEN TO SNUG FIT. REPEAT UNTIL ALL SEAT PLATES ARE ATTACHED.

STEP 2:

- USE 2 - PCS. DIAGONAL BRACE (4)
 2 - PCS. 3/8" X 5 1/2" SS. HEX HD. CAP SCR. (8)
 2 - PCS. 3/8" SS. NYLON LOCK NUT (10)
 8 - PCS. 3/8" ID X 5/8" OD RUBBER WASHER (13)
 4 - PCS. 3/8" S.STL WASHER (14)
 ATTACH DIAGONAL BRACE (4) TO STEP 1 ASSEMBLIES USING HARDWARE (8, 10, 13 & 14). TIGHTEN TO SNUG FIT.

STEP 3:

- USE 2 - PCS. TOP ANGLE (5)
 4 - PCS. 3/8" X 3" SS. HEX HD. CAP SCR. (7)
 4 - PCS. 3/8" SS. NYLON LOCK NUT (10)
 12 - PCS. 3/8" ID X 5/8" OD RUBBER WASHER (13)
 8 - PCS. 3/8" S.STL WASHER (14)
 ATTACH TOP ANGLE (5) TO STEP 2 ASSEMBLIES USING HARDWARE (7, 10, 13 & 14). TIGHTEN TO SNUG FIT.

STEP 4:

- USE 2 - PCS. BOLT PLATE FOR ALUM PLANK, HG (1)
 4 - PCS. 5/16" X 1" SS. HEX HD CAP SCR. (9)
 4 - PCS. 5/16" SS. HEX NUT (11)
 8 - PCS. 5/16" SS. WASHER (12)
 ATTACH BOLT PLATE FOR ALUM PLANK, HG (1) TO STEP 3 ASSEMBLIES USING HARDWARE (9, 11, & 12). TIGHTEN TO SNUG FIT.

STEP 5:

- USE 5 - PCS. 2" X 10" X 6" ALUMINUM PLANK (2)
 20 - PCS. 5/16" X 1" SS. HEX HD. CAP SCR. (9)
 20 - PCS. 5/16" SS. HEX NUT (11)
 20 - PCS. 5/16" SS. FLAT WASHER (12)
 20 - PCS. ALUMINUM CLIP (15)
 PLACE ALUMINUM CLIP (15) OVER HEAD OF 5/16" X 1" SS. HEX HD. CAP SCR. (9). PLACE BOLT WITH CLIP IN HOLES OF END SUPPORT FRAME. THEN PLACE 2" X 10" X 6" ALUMINUM PLANK (2) ON SUPPORT OVER TOP OF ALUMINUM CLIPS. TURN CLIPS 1/4 TURN IN ALUMINUM PLANK TO LOCK INTO POSITION. THEN USE HARDWARE (11 & 12) TO TIGHTEN TO SNUG FIT. REPEAT UNTIL ALL PLANKS ARE ATTACHED.

SEE SHEET 3 FOR
STEP DETAILS AND
ALUM PLANK ASSEMBLY

STEP 6:

- USE 4 - PCS. ALUMINUM CLIP (15)
 4 - PCS. 5/16" X 1" SS. HEX HD. CAP SCR. (9)
 4 - PCS. 5/16" SS. HEX NUT (11)
 4 - PCS. 5/16" SS. FLAT WASHER (12)
 PLACE ALUMINUM CLIP (15) OVER HEAD OF 5/16" X 1" SS. HEX HD. CAP SCR. (9). PLACE BOLT WITH CLIP IN HOLES OF BOLT PLATE FOR ALUM PLANK, HG (1) THEN TURN CLIP 1/4 TURN IN ALUMINUM PLANK TO LOCK INTO PLACE. THEN USE HARDWARE (11 & 12) TO TIGHTEN TO SNUG FIT.

STEP 7:

UPON COMPLETION OF TABLE ASSEMBLY SQUARE ALL COMPONENTS THEN TIGHTEN ALL HARDWARE.

ITEM	QTY	PART NO	DESCRIPTION
1	2	0-71-00HG-08	BOLT PLATE FOR ALUM PLANK, HG
2	5	0-71-60A-01	2" X 10" X 6" ALUMINUM PLANK
3	4	0-72-00-02	END SUPPORT FRAME
4	2	0-72-00-03	DIAGONAL BRACE
5	2	0-72-00-04	TOP ANGLE
6	4	0-72-00-05	SEAT PLATE
7	12	1-12-002	3/8" X 3" SS HEX HD CAP SCR
8	2	1-12-039	3/8" X 5 1/2" SS HEX HD CAP SCR
9	26	1-12-061	5/16" X 1" SS HEX HD CAP SCR
10	14	1-20-007	3/8" SS NYLON LOCKNUT
11	26	1-21-015	5/16" SS HEX NUT
12	28	1-22-017	5/16" SS FLAT WASHER
13	44	1-22-018	3/8" ID X 5/8" OD RUBBER WASHER
14	28	1-22-024	3/8" SS FLAT WASHER
15	24	5-48-083	ALUMINUM CLIPS

DuMor, inc.
 P.O. Box 142 Mifflintown, PA 17059-0142

SCALE : NONE
 DATE DRAWN : 3/22/94
 DRAWN BY : AH
 DATE REV. : 10/11/06
 REV. BY : AWH

TITLE : PICNIC TABLE ASSEMBLY
 REV. G
 DRAWING NUMBER 72 SERIES A
 SHEET 2 OF 3

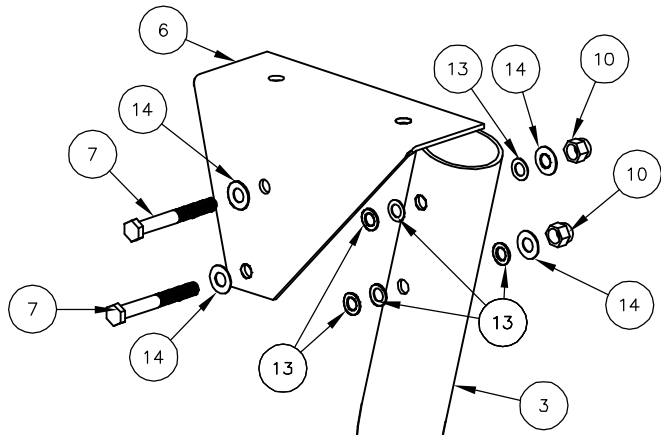

STEP 1

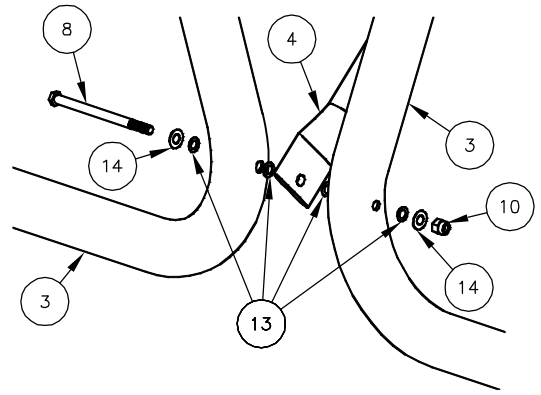

STEP 2

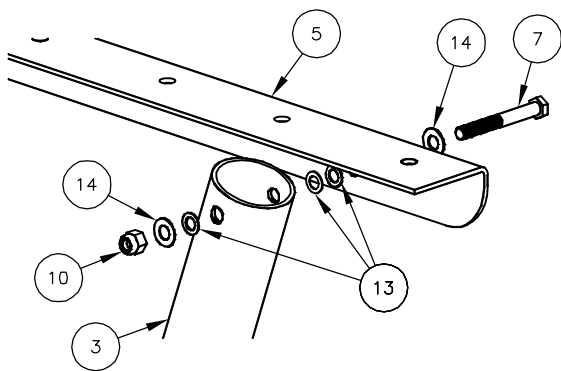

STEP 3

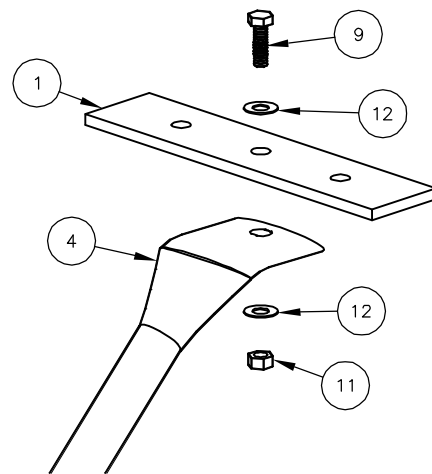

STEP 4

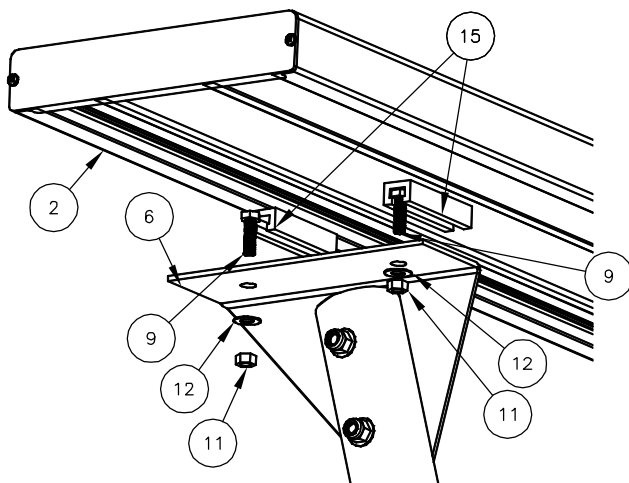

STEP 5

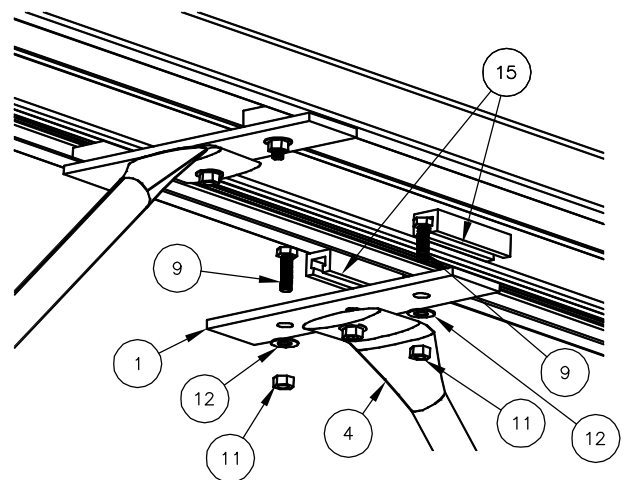

STEP 6

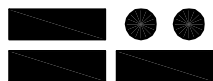

DuMor, inc.

P.O. Box 142 Mifflintown, PA 17059-0142

SCALE : NONE
 DATE DRAWN : 3/22/94
 DRAWN BY : AH
 DATE REV. : 10/11/06
 REV. BY : AWH

TITLE : PICNIC TABLE ASSEMBLY

REV. G

DRAWING NUMBER

72 SERIES A

SHEET 3 OF 3