

S-2 SURFACE MT

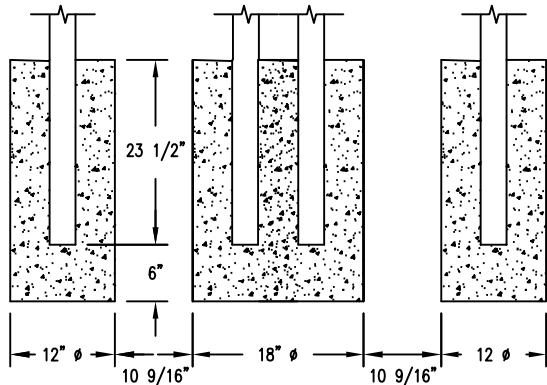

S-1 EMBEDMENT

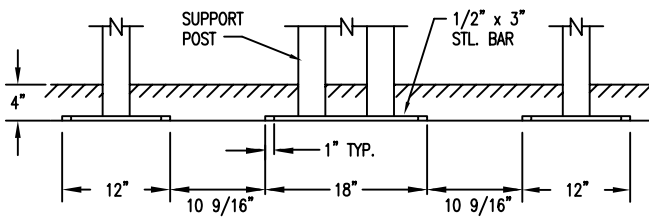
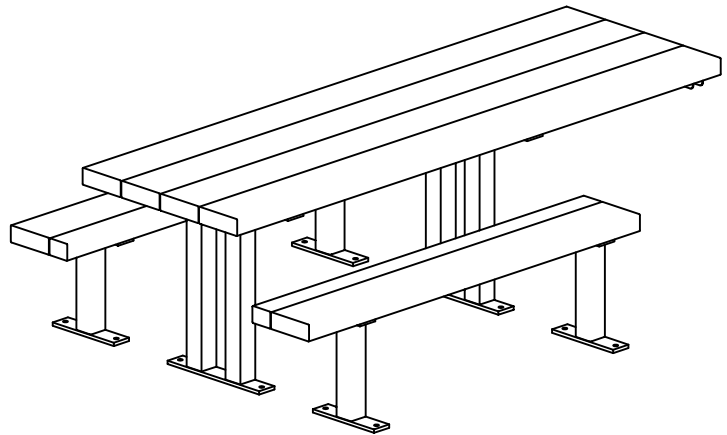

S-4 SUB FLOOR

NOTES

- 1.) ALL STL. MEMBERS COATED W/ ZINC RICH EPOXY THEN FINISHED W/ POLYESTER POWDER COATING.
- 2.) ALL WOOD MEMBERS TREATED W/ CLEAR PRESERVATIVE.
- 3.) 1/2" X 3 3/4" EXPANSION ANCHOR BOLTS PROVIDED FOR OPTIONS S-2 AND S-4.

WOOD OPTIONS

- CLEAR ALL HEART REDWOOD S4S EE
- 'C' & BTR. DOUGLAS FIR KD S4S EE
- OTHER \_\_\_\_\_

  
**DuMor, inc.**  
 P.O. Box 142 Mifflintown, PA 17059-0142

SCALE : NONE  
 DATE DRAWN : 3/22/94  
 DRAWN BY : AH  
 DATE REV. : 12/15/08  
 REV. BY : ESS

TITLE : PICNIC TABLE  
 REV. D  
 DRAWING NUMBER 75-68-1  
 SHEET 1 OF 2

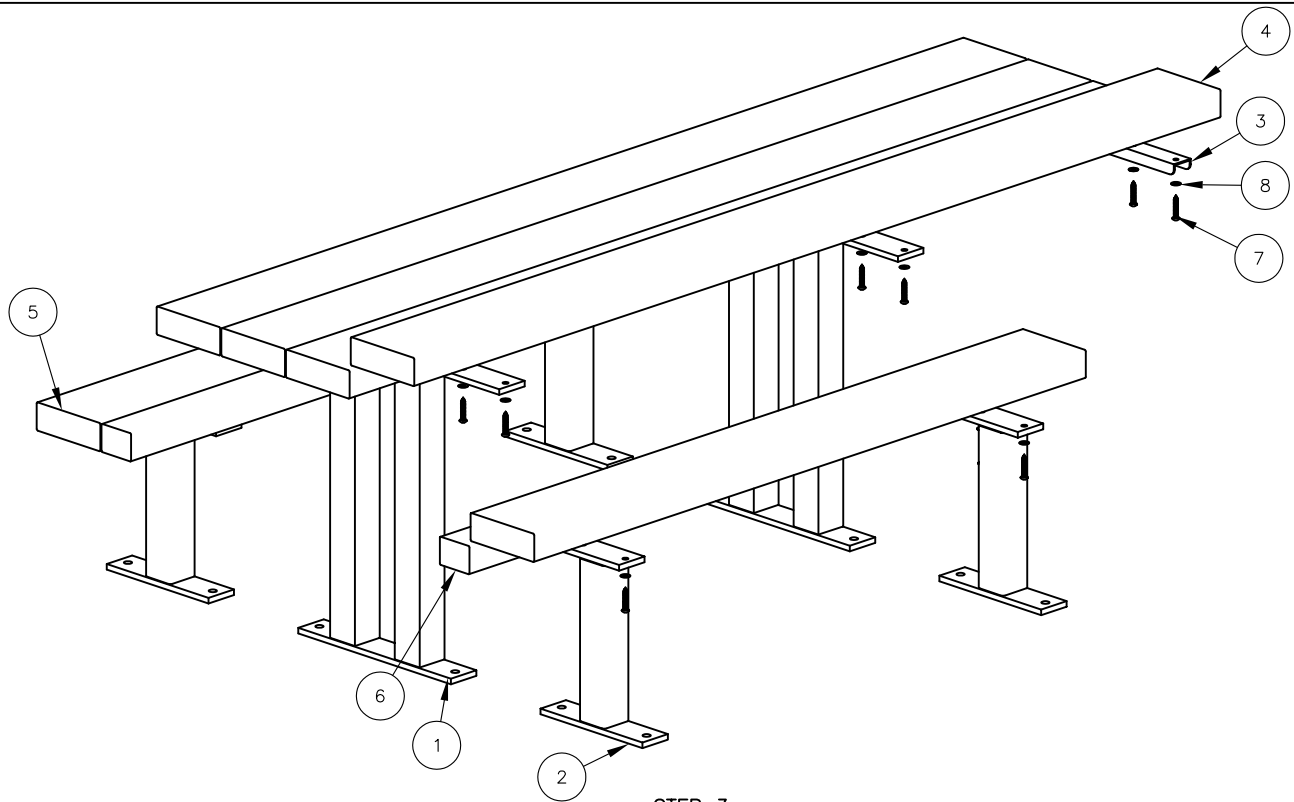

**NOTES:**

- 1.) DURING ASSEMBLY PROCEDURE;  
DO NOT COMPLETELY TIGHTEN HARDWARE.
- 2.) THE ACTUAL PARTS WILL NOT BE NUMBERED;  
NUMBERS ONLY APPLY TO DRAWING.
- 3.) SEE SPEC. SHEET 1 FOR MOUNTING DETAILS.

**STEP 1:**

USE 2 - PCS. SUPPORT POST FOR SURFACE MOUNT ( 1 )  
 4 - PCS. 3" X 8" X 95" WOOD SLAT ( 4 )  
 16 - PCS. 3/8" X 2" SS. BTN. HD. LAG SCR. ( 7 )  
 16 - PCS. 3/8" SS. FLAT WASHER ( 8 )  
 ATTACH 3" X 8" X 95" TABLE SLAT ( 4 ) TO SUPPORT  
 POST FOR SURFACE MOUNT ( 1 ) USING HARDWARE  
 ( 7 & 8 ). TIGHTEN TO SNUG FIT. REPEAT UNTIL ALL  
 SLATS ARE ATTACHED.

**STEP 2:**

USE 1 - PC. END CHANNEL ( 3 )  
 8 - PCS. 3/8" X 2" SS. BTN. HD. LAG SCR. ( 7 )  
 8 - PCS. 3/8" SS. FLAT WASHER ( 8 )  
 ATTACH END CHANNEL ( 3 ) TO STEP 1 ASSEMBLY  
 USING HARDWARE ( 7 & 8 ). TIGHTEN TO SNUG FIT.

**STEP 3:**

USE 4 - PCS. SEAT SUPPORT FOR SURFACE MOUNT ( 2 )  
 2 - PCS. 3" X 8" X 65" SEAT SLAT ( 5 )  
 2 - PCS. 3" X 4" X 65" SEAT SLAT ( 6 )  
 12 - PCS. 3/8" X 2" SS. BTN. HD. LAG SCR. ( 7 )  
 12 - PCS. 3/8" SS. FLAT WASHER ( 8 )  
 ATTACH 3" X 8" X 65" SEAT SLAT ( 5 ) AND 3" X 4" X  
 65" SEAT SLAT ( 6 ) TO SEAT SUPPORT FOR SURFACE  
 MOUNT ( 2 ) USING HARDWARE ( 7 & 8 ). BE SURE  
 3" X 8" WOOD SLAT IS LOCATED OVER THE SUPPORTS SQ.  
 TUBE. TIGHTEN TO SNUG FIT. REPEAT UNTIL ALL SLATS ARE  
 ATTACHED.

**STEP 4:**

UPON COMPLETION OF TABLE ASSEMBLY  
 SQUARE ALL COMPONENTS THEN TIGHTEN  
 ALL HARDWARE.

**STEP 5:**

ANCHOR ACCORDING TO SUPPORT OPTION USED.

ITEM	QTY	PART NO	DESCRIPTION
1	2	0-75-00-03/S-2	TABLE SUPPORT FOR SURFACE MOUNT
2	4	0-75-00-04/S-2	SEAT SUPPORT FOR SURFACE MOUNT
3	1	0-75-68-05	END CHANNEL
4	4	0-75-68-1-01	3" X 8" X 95" WHLCHR TOP PLANK
5	2	0-75-68-1-02	3" X 8" X 65" WOOD SLAT
6	2	0-75-68-1-03	3" X 4" X 65" WOOD SLAT
7	36	1-13-016	3/8" X 2" SS BTN SKT HD LAG SCR
8	36	1-22-024	3/8" SS FLAT WASHER

**DuMor, inc.**  
 P.O. Box 142 Mifflintown, PA 17059-0142

SCALE : NONE  
 DATE DRAWN : 3/22/94  
 DRAWN BY : AH  
 DATE REV. : 12/15/08  
 REV. BY : ESS

TITLE : PICNIC TABLE ASSEMBLY

REV. D	DRAWING NUMBER 75-68-1	SHEET 2 OF 2
--------	------------------------	--------------