

FINISH OPTIONS:

- ALL STL. MEMBERS COATED W/ ZINC RICH EPOXY THEN FINISHED W/ POLYESTER POWDER COATING.
- HOT DIP GALV. AFTER FABRICATION.

LENGTH OPTIONS

- 6' TABLE
- 8' TABLE



DuMor, inc.

P.O. Box 142 Mifflintown, PA 17059-0142

SCALE : NONE
 DATE DRAWN : 3/22/94
 DRAWN BY : CDC
 DATE REV. : 10/15/01
 REV. BY : JSB

TITLE : PICNIC TABLE

REV. F

DRAWING NUMBER

77 SERIES A

SHEET 1 OF 2

NOTE:

- 1.) DURING ASSEMBLY PROCEDURE;
DO NOT COMPLETELY TIGHTEN HARDWARE.
- 2.) THE ACTUAL PARTS WILL NOT BE NUMBERED;
NUMBERS ONLY APPLY TO DRAWING.

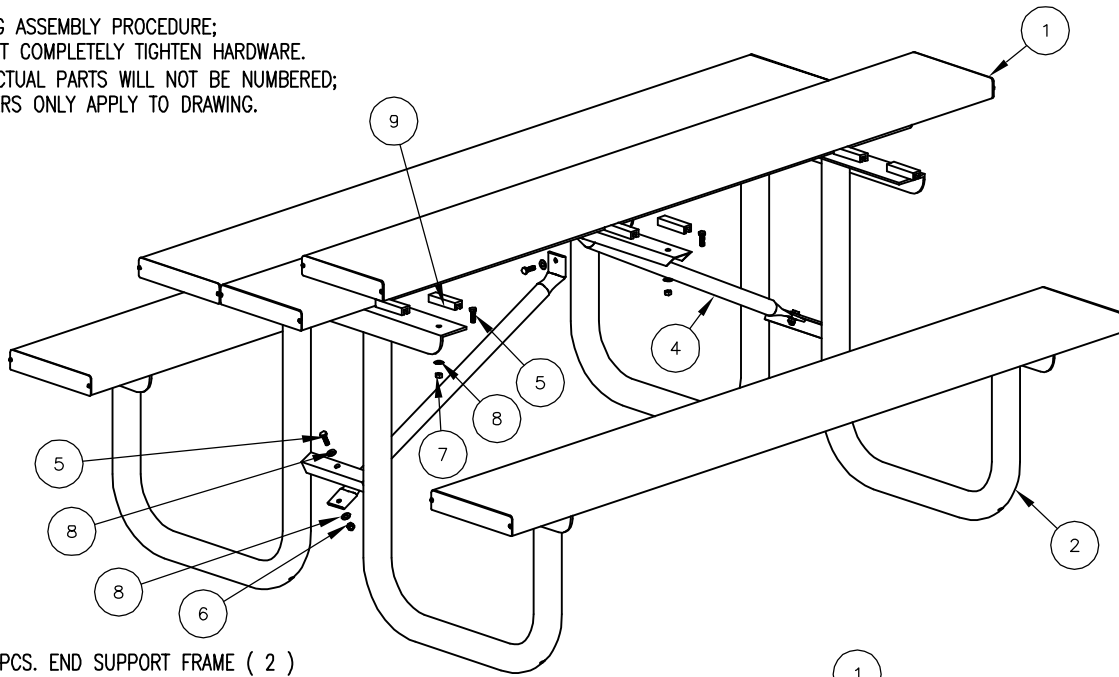

STEP 1:

- USE 2 - PCS. END SUPPORT FRAME (2)
 5 - PCS. 2" X 10" X 6' ALUMINUM PLANK (1)
 20 - PCS. 5/16" X 1" SS HEX CAP SCR (5)
 20 - PCS. 5/16" SS HEX NUT (7)
 20 - PCS. 5/16" SS FLAT WASHER (8)
 20 - PCS. ALUMINUM CLIPS (9)

PLACE ALUMINUM CLIP (9) OVER HEAD OF 5/16" X 1" SS. HEX HD. CAP SCR. (5). PLACE BOLT WITH CLIP IN END SUPPORT FRAME (2) THEN PLACE 2" X 10" ALUMINUM PLANK (1) ON SUPPORTS OVER TOP OF ALUMINUM CLIP. TURN CLIP 1/4 IN ALUMINUM PLANK TO LOCK INTO PLACE. THEN USE HARDWARE (5, 7 & 8) TO TIGHTEN TO SNUG FIT.

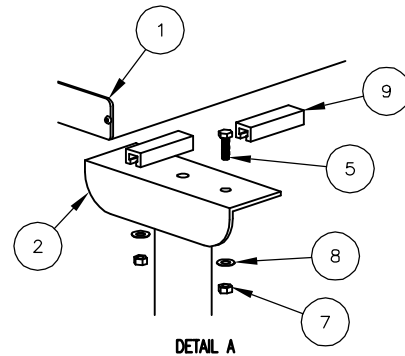

STEP 2:

- USE 1 - PC. CENTER/END CHANNEL (3)
 2 - PCS. DIAGONAL BRACE (4)
 2 - PCS. 5/16" X 1" SS. HEX HD CAP SCREW (5)
 2 - PCS. 5/16" SS. NYLON LOCK NUT (6)
 4 - PCS. 5/16" SS. FLAT WASHER (8)

ATTACH CENTER/END CHANNEL (3) TO DIAGONAL BRACE (4) USING HARDWARE (5, 7, & 8) TIGHTEN TO SNUG FIT.

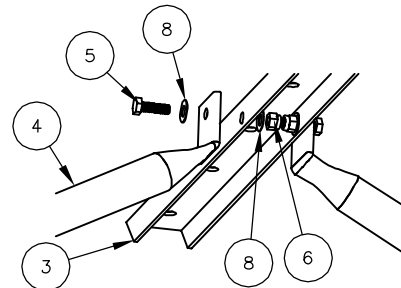

STEP 3:

- USE 8 - PCS. 5/16" X 1" SS. HEX HD CAP SCREW (5)
 2 - PCS. 5/16" SS. NYLON LOCK NUT (6)
 6 - PCS. 5/16" SS. HEX NUT (7)
 10 - PCS. 5/16" SS. FLAT WASHER (8)
 6 - PCS. ALUMINUM CLIPS (9)

ATTACH STEP 2 DIAGONAL BRACE TO STEP 1 END SUPPORT FRAME USING HARDWARE (5, 6, & 8). TIGHTEN TO SNUG FIT. NEXT SQUARE TABLE BEFORE ATTACHING CENTER/END CHANNEL (3) TO 2" X 10" ALUMINUM TOP PLANKS (1). PLACE ALUMINUM CLIP (9) OVER HEAD OF 5/16" X 1" SS. HEX HD. CAP SCR. (5). PLACE BOLT WITH CLIP IN CENTER/END CHANNEL (3). TURN CLIP 1/4 TURN IN ALUMINUM PLANK TO LOCK INTO PLACE. THEN USE HARDWARE (7 & 8) TO TIGHTEN TO SNUG FIT.

STEP 4:

UPON COMPLETION OF TABLE ASSEMBLY TIGHTEN ALL HARDWARE.

ITEM	QTY	PART NO	DESCRIPTION
1	5	0-71-60A-01	2" X 10" X 6' ALUMINUM PLANK
2	2	0-77-00-01	END SUPPORT FRAME
3	1	0-77-00-03	CENTER/END CHANNEL
4	2	0-77-60-02	DIAGONAL BRACE FOR 6' TABLE
5	30	1-12-061	5/16" X 1" SS HEX HD CAP SCR
6	4	1-20-016	5/16" SS NYLON LOCKNUT
7	26	1-21-015	5/16" SS HEX NUT
8	34	1-22-017	5/16" SS FLAT WASHER
9	26	5-48-083	ALUMINUM CLIPS

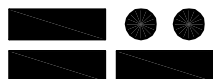

DuMor, inc.

P.O. Box 142 Mifflintown, PA 17059-0142

SCALE : NONE

DATE DRAWN : 3/22/94

DRAWN BY : CDC

DATE REV. : 10/15/01

REV. BY : JSB

TITLE :

PICNIC TABLE ASSEMBLY

REV. F

DRAWING NUMBER

77 SERIES A

SHEET 2 OF 2