

NOTE:

- 1.) 1/2" X 3 3/4" EXPANSION ANCHORS AND 2" PIPE CLAMPS PROVIDED ( 4 - PCS )

FINISH OPTIONS:

- ALL STL. MEMBERS COATED W/ ZINC RICH EPOXY THEN FINISHED W/ POLYESTER POWDER COATING.
- HOT DIP GALV. AFTER FABRICATION.

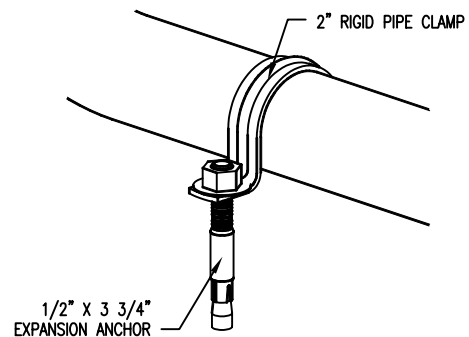

ANCHORING DETAIL



**DuMor, inc.**  
P.O. Box 142 Mifflintown, PA 17059-0142

SCALE : NONE  
DATE DRAWN : 3/22/94  
DRAWN BY : CDC  
DATE REV. : 2/18/08  
REV. BY : AWH

TITLE : PICNIC TABLE

REV. G

DRAWING NUMBER

77-68-1A

SHEET 1 OF 2

**NOTE:**

- 1.) DURING ASSEMBLY PROCEDURE;  
DO NOT COMPLETELY TIGHTEN HARDWARE.
- 2.) THE ACTUAL PARTS WILL NOT BE NUMBERED;  
NUMBERS ONLY APPLY TO DRAWING.
- 3.) SEE SPEC. SHEET 1 FOR MOUNTING DETAILS

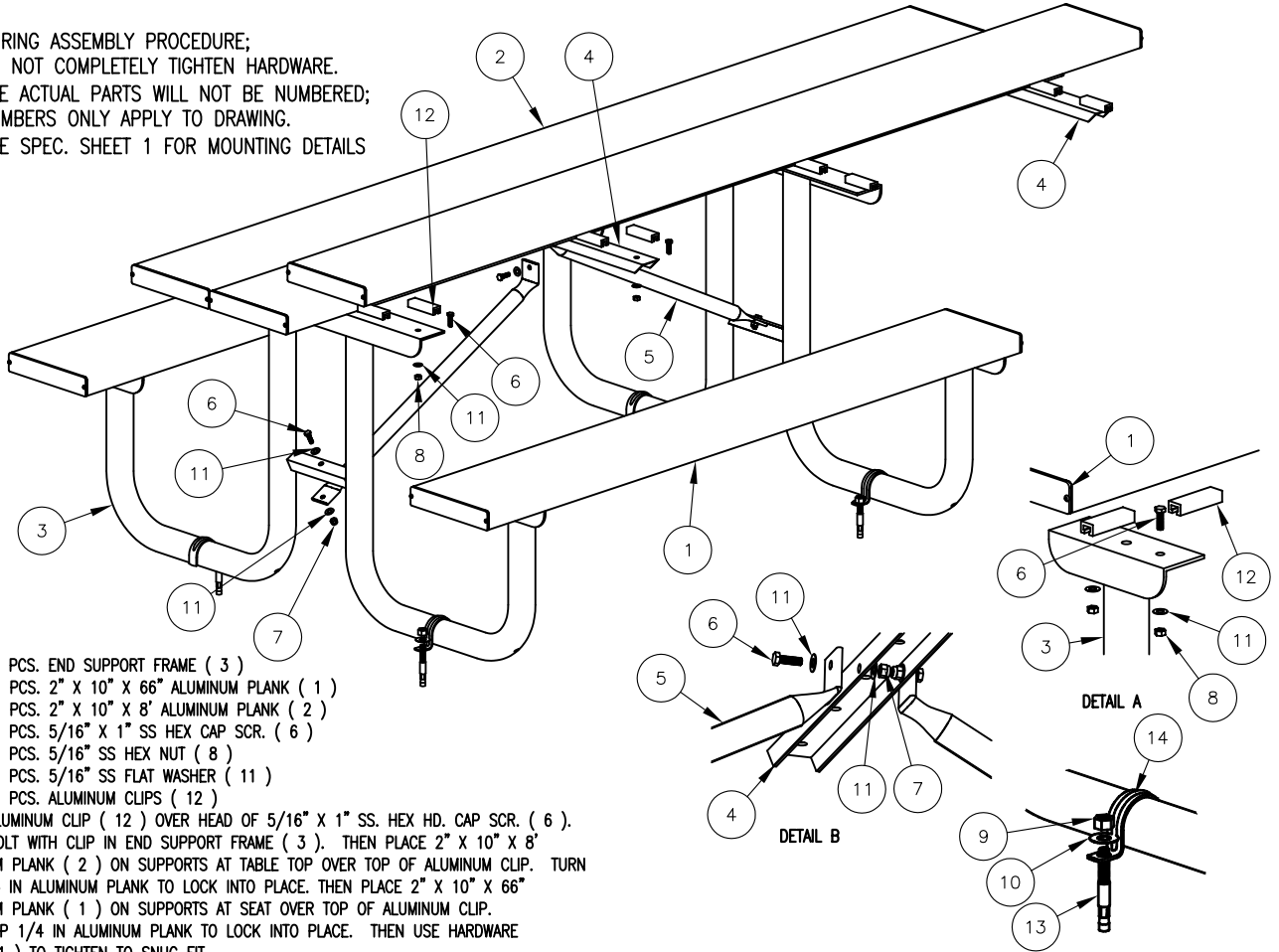

**STEP 1:**

- USE 2 - PCS. END SUPPORT FRAME ( 3 )  
 2 - PCS. 2" X 10" X 66" ALUMINUM PLANK ( 1 )  
 3 - PCS. 2" X 10" X 8' ALUMINUM PLANK ( 2 )  
 20 - PCS. 5/16" X 1" SS HEX CAP SCR. ( 6 )  
 20 - PCS. 5/16" SS HEX NUT ( 8 )  
 20 - PCS. 5/16" SS FLAT WASHER ( 11 )  
 20 - PCS. ALUMINUM CLIPS ( 12 )

PLACE ALUMINUM CLIP ( 12 ) OVER HEAD OF 5/16" X 1" SS. HEX HD. CAP SCR. ( 6 ).  
 PLACE BOLT WITH CLIP IN END SUPPORT FRAME ( 3 ). THEN PLACE 2" X 10" X 8'  
 ALUMINUM PLANK ( 2 ) ON SUPPORTS AT TABLE TOP OVER TOP OF ALUMINUM CLIP. TURN  
 CLIP 1/4 IN ALUMINUM PLANK TO LOCK INTO PLACE. THEN PLACE 2" X 10" X 66"  
 ALUMINUM PLANK ( 1 ) ON SUPPORTS AT SEAT OVER TOP OF ALUMINUM CLIP.  
 TURN CLIP 1/4 IN ALUMINUM PLANK TO LOCK INTO PLACE. THEN USE HARDWARE  
 ( 8 & 11 ) TO TIGHTEN TO SNUG FIT.

**STEP 2:**

- USE 1 - PC. CENTER/END CHANNEL ( 4 )  
 2 - PCS. DIAGONAL BRACE FOR 6' TABLE ( 5 )  
 2 - PCS. 5/16" X 1" SS. HEX HD CAP SCREW ( 6 )  
 2 - PCS. 5/16" SS. NYLON LOCK NUT ( 7 )  
 2 - PCS. 5/16" SS. FLAT WASHER ( 11 )

ATTACH DIAGONAL BRACE FOR 6' TABLE ( 5 ) TO CENTER/END CHANNEL  
 ( 4 ) USING HARDWARE ( 6, 7, & 11 ) TIGHTEN TO SNUG FIT.

**STEP 3:**

- USE 8 - PCS. 5/16" X 1" SS. HEX HD CAP SCREW ( 6 )  
 2 - PCS. 5/16" SS. NYLON LOCK NUT ( 7 )  
 6 - PCS. 5/16" SS. HEX NUT ( 8 )  
 10 - PCS. 5/16" SS. FLAT WASHER ( 11 )  
 6 - PCS. ALUMINUM CLIPS ( 12 )

ATTACH STEP 2 DIAGONAL BRACE TO STEP 1 END SUPPORT FRAME USING HARDWARE  
 ( 6, 7, & 11 ). TIGHTEN TO SNUG FIT. NEXT SQUARE TABLE BEFORE ATTACHING  
 CENTER/END CHANNEL ( 4 ) TO 2" X 10" X 96" ALUMINUM TOP PLANKS ( 2 ).  
 PLACE ALUMINUM CLIP ( 12 ) OVER HEAD OF 5/16" X 1" SS. HEX HD. CAP SCR.  
 ( 6 ). PLACE BOLT WITH CLIP IN CENTER/ END CHANNEL ( 4 ). TURN CLIP 1/4  
 TURN IN ALUMINUM PLANK TO LOCK INTO PLACE. THEN USE HARDWARE ( 8 & 11 )  
 TO TIGHTEN TO SNUG FIT.

**STEP 4:**

- USE 1 - PC. CENTER/END CHANNEL ( 4 )  
 6 - PCS. 5/16" X 1" SS HEX CAP SCR. ( 6 )  
 6 - PCS. 5/16" SS. HEX NUT ( 8 )  
 6 - PCS. 5/16" SS. FLAT WASHER ( 11 )  
 6 - PCS. ALUMINUM CLIPS ( 12 )

PLACE ALUMINUM CLIP ( 12 ) OVER HEAD OF 5/16" X 1" SS. HEX HD. CAP  
 SCR. ( 6 ). PLACE BOLT WITH CLIP IN CENTER/END CHANNEL ( 4 ).  
 THEN PLACE CENTER/END CHANNEL ( 4 ) APPROX. 4" IN FROM OVERHANG  
 END OF STEP 1. TURN CLIPS 1/4 TURN IN ALUMINUM PLANK TO LOCK  
 INTO PLACE. USE HARDWARE ( 8 & 11 ) TO TIGHTEN TO SNUG FIT.

**STEP 5:**

UPON COMPLETION OF TABLE ASSEMBLY TIGHTEN ALL HARDWARE.

**STEP 6:**

- 4 - PCS. 1/2" SS. HEX NUT ( 9 )  
 4 - PCS. 1/2" SS. FLAT WASHER ( 10 )  
 4 - PCS. 1/2" X 3 3/4" EXPANSION ANCHORS ( 13 )  
 4 - PCS. 2" RIGID PIPE CLAMP ( 14 )

PLACE TABLE IN SITE LOCATION DESIRED. PLACE 2" RIGID  
 PIPE CLAMP IN CENTER OF TABLE LEGS. MARK HOLES  
 AND MOVE 2" RIGID PIPE CLAMPS. DRILL 1/2" DIA HOLE  
 IN CONCRETE AT MARKED HOLE LOCATIONS APPROX. 3 1/2" DEEP.  
 BLOW OUT DUST IN DRILLED HOLES. PLACE 1/2" X 3 3/4"  
 EXPANSION ANCHORS IN HOLES. PLACE NUT TO FLUSH  
 WITH END AND DRIVE INTO GROUND. REMOVE NUT AND PLACE  
 2" RIGID PIPE CLAMPS OVER TABLE LEGS AND ON 1/2" X 3 3/4"  
 EXPANSION ANCHORS. ATTACH WASHER AND NUT AND TIGHTEN.

ITEM	QTY	PART NO	DESCRIPTION
1	2	0-71-68-1A-01	2" X 10" X 66" ALUMINUM PLANK
2	3	0-71-80A-01	2" X 10" X 8' ALUMINUM PLANK
3	2	0-77-00-01	END SUPPORT FRAME
4	2	0-77-00-03	CENTER/END CHANNEL
5	2	0-77-60-02	DIAGONAL BRACE FOR 6' TABLE
6	36	1-12-061	5/16" X 1" SS HEX HD CAP SCR
7	4	1-20-016	5/16" SS NYLON LOCKNUT
8	32	1-21-015	5/16" SS HEX NUT
9	4	1-21-016	1/2" SS HEX NUT
10	4	1-22-015	1/2" SS FLAT WASHER
11	40	1-22-017	5/16" SS FLAT WASHER
12	32	5-48-083	ALUMINUM CLIPS
13	4	1-17-003	1/2" X 3 3/4" SS EXPANSION ANCHOR
14	4	5-48-492	2" RIGID PIPE CLAMP, 9/16" DIA HOLE, PLTD

**DuMor, inc.**  
 P.O. Box 142 Mifflintown, PA 17059-0142

SCALE : NONE  
 DATE DRAWN : 3/22/94  
 DRAWN BY : CDC  
 DATE REV. : 2/18/08  
 REV. BY : AWH

TITLE : PICNIC TABLE ASSEMBLY  
 REV. G DRAWING NUMBER 77-68-1A SHEET 2 OF 2