

NOTES:

- 1.) ALL STL. MEMBERS COATED W/ ZINC RICH EPOXY THEN FINISHED W/ POLYESTER POWDER COATING.

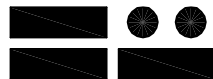

DuMor, inc.

P.O. Box 142 Mifflintown, PA 17059-0142

SCALE : NONE
 DATE DRAWN : 7/26/95
 DRAWN BY : AH
 DATE REV. : 12/14/98
 REV. BY : JSB

TITLE : TEAM BENCH

REV. A

DRAWING NUMBER 99-120A/S-5

SHEET 1 OF 2

NOTE:

- 1.) DURING ASSEMBLY PROCEDURE;
DO NOT COMPLETELY TIGHTEN HARDWARE.
- 2.) THE ACTUAL PARTS WILL NOT BE NUMBERED:
NUMBERS ONLY APPLY TO DRAWING.

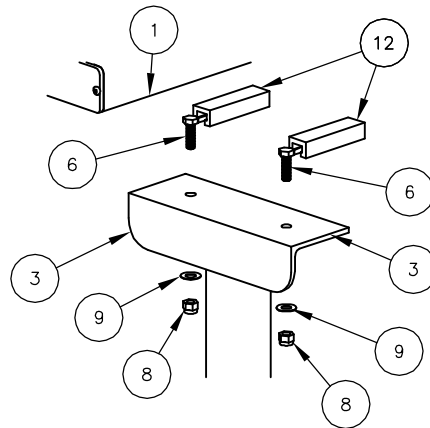
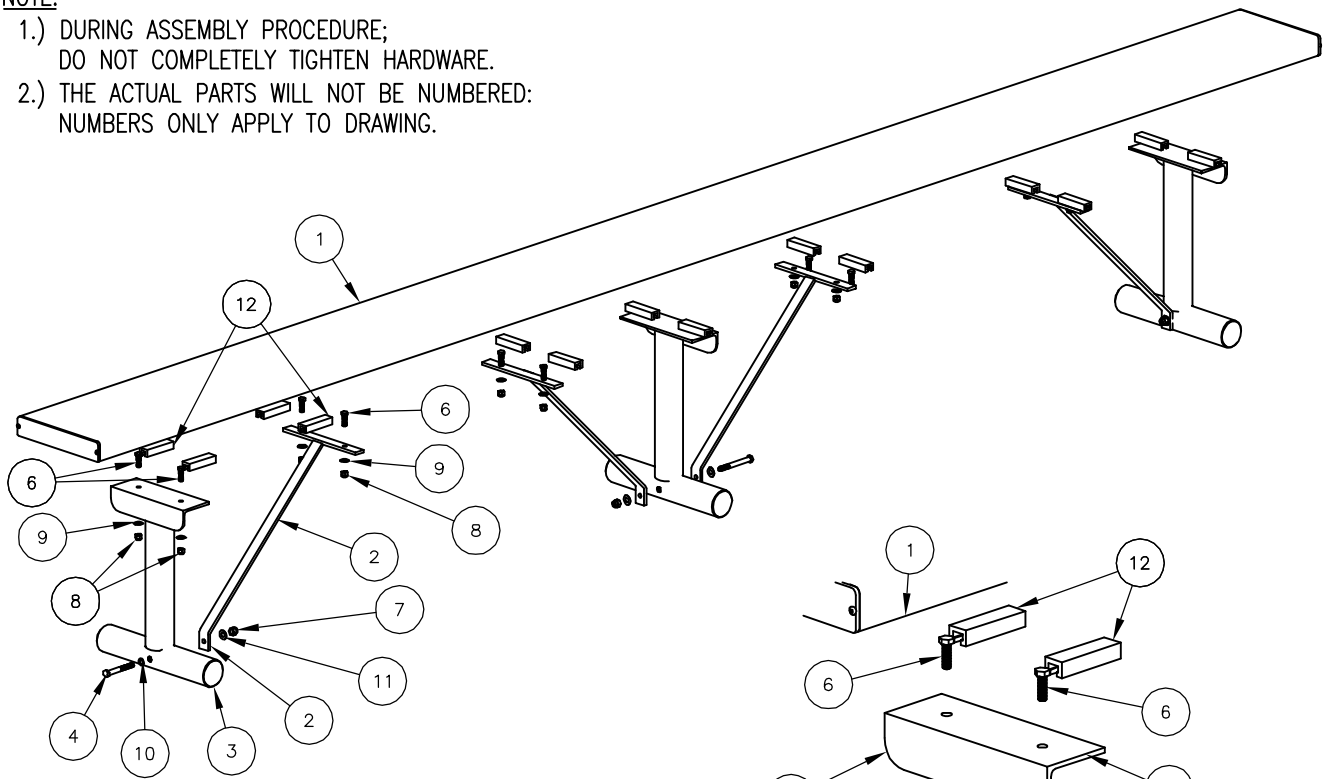

STEP 1:

- USE 1 - PC. 2" X 10" X 12' ALUMINUM PLANK (1)
- 3 - PCS. FREE STANDING SUPPORT (3)
- 6 - PCS. ALUMINUM CLIPS (12)
- 6 - PCS. 5/16" X 1" SS. HEX HD. CAP SCR. (6)
- 6 - PCS. 5/16" SS. LOCK NUT (8)
- 6 - PCS. 5/16" SS. FLAT WASHER (9)

PLACE ALUMINUM CLIP (12) OVER HEAD OF 5/16" X 1" SS. HEX HD. CAP SCR. (6). PLACE BOLT WITH CLIP IN FREE STANDING SUPPORT POST (3) THEN PLACE 2" X 10" X 12' ALUMINUM PLANK (1) ON SUPPORT OVER TOP OF ALUMINUM CLIP. TURN CLIP 1/4 TURN IN ALUMINUM PLANK TO LOCK INTO PLACE. THEN USE HARDWARE (8 & 9) TO TIGHTEN TO SNUG FIT.

STEP 2:

- USE 2 - PCS. DIAGONAL BRACE (T) (2)
- 2 - PCS. 3/8" X 3" SS. HEX HD. CAP SCR. (4)
- 2 - PCS. 3/8" ID X 5/8" OD RUBBER WASHER (10)
- 2 - PCS. 3/8" SS FLAT WASHER (11)
- 2 - PCS. 3/8" SS. NYLON LOCK NUT (7)

ATTACH DIAGONAL BRACE (T) (2) TO INSIDE OF EACH END SUPPORT IN STEP 1 ASSEMBLY USING HARDWARE (4, 7, 10, & 11). TIGHTEN TO SNUG FIT.

STEP 3:

- USE 2 - PCS. DIAGONAL BRACE (T) (2)
- 1 - PC. 3/8" X 3 1/2" SS. HEX HD. CAP SCR. (5)
- 2 - PCS. 3/8" SS. FLAT WASHERS (11)
- 1 - PCS. 3/8" SS. NYLON LOCK NUT (7)

ATTACH DIAGONAL BRACES (2) TO EACH SIDE OF CENTER SUPPORT IN STEP 2 ASSEMBLY. USING HARDWARE (5, 7, & 11). TIGHTEN TO SNUG FIT.

STEP 4:

- USE 8 - PCS. ALUMINUM CLIPS (12)
- 8 - PCS. 5/16" X 1" SS. HEX HD CAP SCR (6)
- 8 - PCS. 5/16" SS. NYLON LOCK NUT (8)
- 8 - PCS. 5/16" SS. FLAT WASHER (9)

SLIDE ALUMINUM CLIP (12) OVER HEAD OF 5/16" X 1" SS. HEX HD. CAP SCR. (6). PLACE BOLT & CLIP IN TOP OF DIAGONAL BRACE TO ATTACH BRACE TO ALUMINUM PLANK. TURN CLIP 1/4 TURN IN ALUMINUM PLANK TO LOCK INTO PLACE. THEN USE HARDWARE (8 & 9) TO TIGHTEN TO SNUG FIT.

STEP 5:

UPON COMPLETION OF BENCH ASSEMBLY SQUARE ALL COMPONENTS THEN TIGHTEN ALL HARDWARE.

ITEM	QTY	PART NO	DESCRIPTION
1	1	0-71-120A-01	2" X 10" X 12' ALUM. PLANK
2	4	0-97-00-02	DIAGONAL BRACE (T)
3	3	0-99-00-01/S-5	FREE-STANDING SUPPORT
4	2	1-12-002	3/8" X 3" SS HEX HD CAP SCR
5	1	1-12-034	3/8" X 3 1/2" SS HEX HD CAP SCR
6	14	1-12-061	5/16" X 1" SS HEX HD CAP SCR
7	3	1-20-007	3/8" SS NYLON LOCKNUT
8	14	1-20-016	5/16" SS NYLON LOCKNUT
9	14	1-22-017	5/16" SS FLAT WASHER
10	2	1-22-018	3/8" ID X 5/8" OD RUBBER WASHER
11	4	1-22-024	3/8" SS FLAT WASHER
12	14	5-48-083	ALUMINUM CLIPS

DuMor, inc.
P.O. Box 142 Mifflintown, PA 17059-0142

SCALE : NONE
DATE DRAWN : 12/21/99
DRAWN BY : JSB
DATE REV. :
REV. BY :

TITLE : BENCH ASSEMBLY
REV. A
DRAWING NUMBER 99-120 A /S-5
SHEET 2 OF 2