

S-2 SURFACE

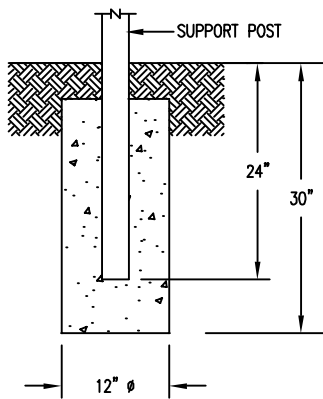

S-1 EMBEDMENT

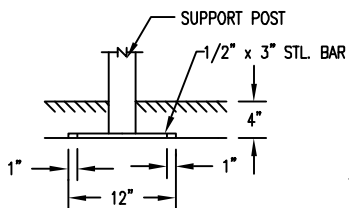
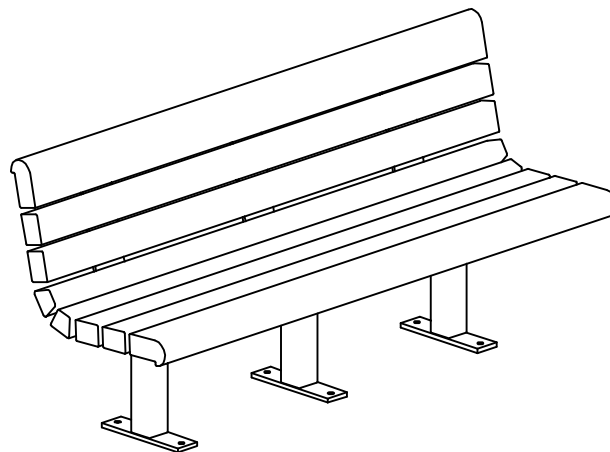

S-4 SUB FLOOR

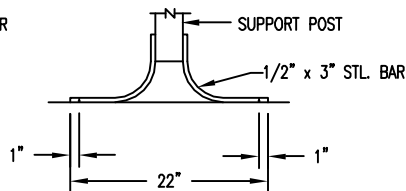

S-3 GULL WING

LENGTH OPTIONS

- 6' BENCH
- 8' BENCH

SLAT OPTIONS

- "CEDAR" RECYCLED PLASTIC
- "GREY" RECYCLED PLASTIC
- "REDWOOD" RECYCLED PLASTIC
- "WALNUT" RECYCLED PLASTIC
- OTHER \_\_\_\_\_

NOTES

- 1.) ALL STL. MEMBERS COATED W/ ZINC RICH EPOXY THEN FINISHED W/ POLYESTER POWDER COATING.
- 2.) 1/2" X 3 3/4" EXPANSION ANCHOR BOLT PROVIDED FOR S-2, S-3 & S-4 OPTIONS.

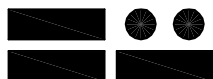

**DuMor, inc.**

P.O. Box 142 Mifflintown, PA 17059-0142

SCALE : NONE  
 DATE DRAWN : 7/31/95  
 DRAWN BY : AH  
 DATE REV. : 10/25/11  
 REV. BY : RDH

TITLE : BENCH

REV. D

DRAWING NUMBER

88 SERIES PL

SHEET 1 OF 2

SURFACE MOUNT  
OPTION SHOWN

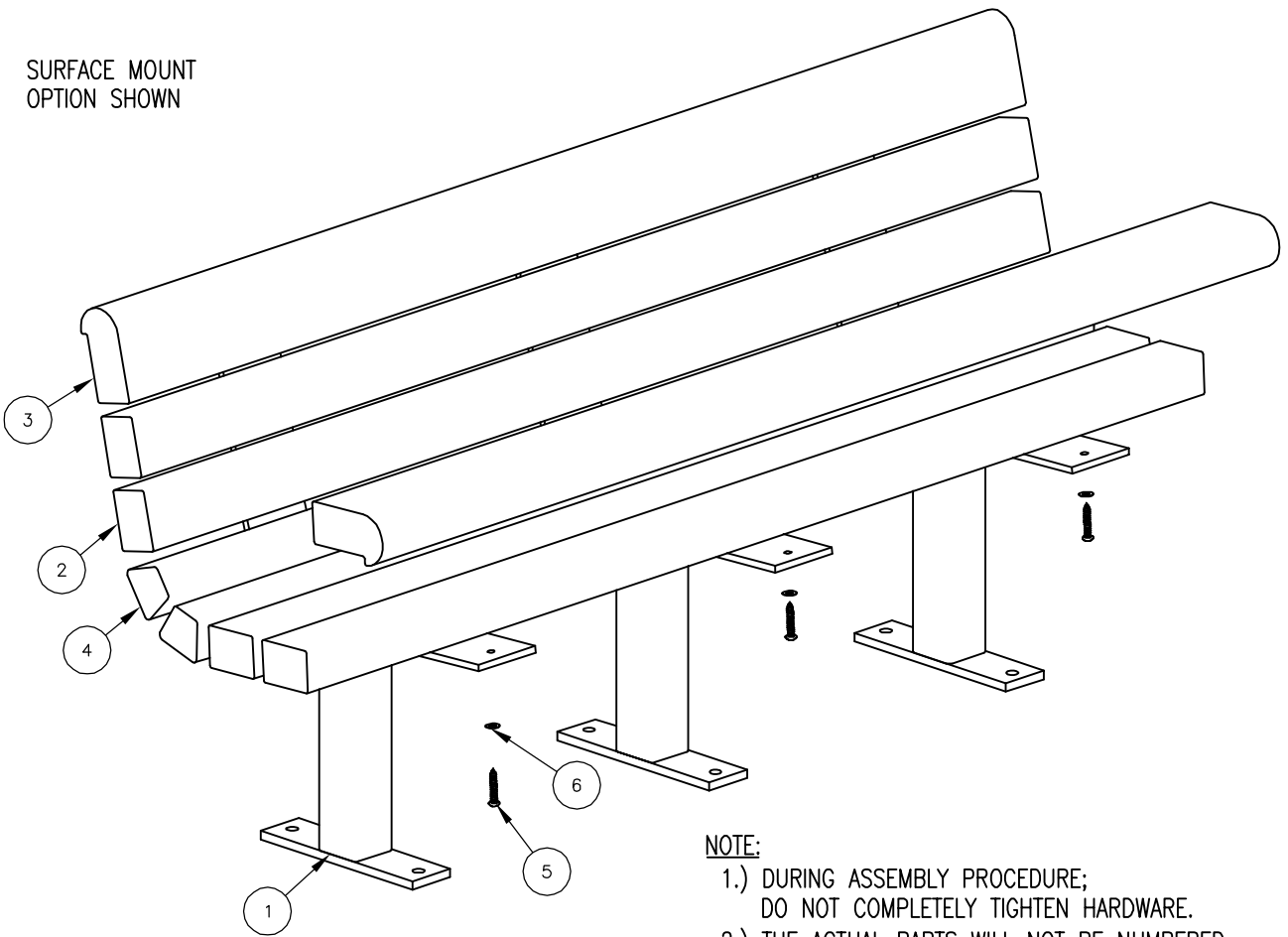

**NOTE:**

- 1.) DURING ASSEMBLY PROCEDURE;  
DO NOT COMPLETELY TIGHTEN HARDWARE.
- 2.) THE ACTUAL PARTS WILL NOT BE NUMBERED:  
NUMBERS ONLY APPLY TO DRAWING.
- 3.) SEE SPEC. SHEET 1 FOR MOUNTING OPTION.

**STEP 1:**

- USE 3 - PCS. SUPPORT FOR SURFACE MOUNT ( 1 )
- 4 - PCS. 3" X 4" X 71" PLASTIC INT'R SLAT ( 2 )
- 2 - PCS. 71" PLASTIC EDGE SLAT ( 3 )
- 2 - PCS. 71" PLASTIC TRAP SLAT ( 4 )
- 24 - PCS. 3/8" X 2" SS. BTN. SKT. HD. LAG SCR. ( 5 )
- 24 - PCS. 3/8" SS. FLAT WASHER ( 6 )

ATTACH SLATS ( 2, 3, & 4 ) TO SUPPORT FOR SURFACE MOUNT ( 1 ) USING HARDWARE ( 5 & 6 ). TIGHTEN TO SNUG FIT.  
REPEAT UNTIL ALL SLATS ARE ATTACHED.

**STEP 2:**

UPON COMPLETION OF BENCH ASSEMBLY SQUARE ALL COMPONENTS THEN TIGHTEN ALL HARDWARE.

**STEP 3:**

ANCHOR ACCORDING TO SUPPORT OPTION USED.

ITEM	QTY	PART NO	DESCRIPTION
1	3	0-88-00-01/S-2	BENCH SUPPORT FOR SURFACE MOUNT
2	4	0-88-60PL-02	3" X 4" X 71" PLASTIC INT'R SLAT
3	2	0-88-60PL-03	71" PLASTIC EDGE SLAT
4	2	0-88-60PL-04	71" PLASTIC TRAP SLAT
5	24	1-13-016	3/8" X 2" SS BTN SKT HD LAG SCR
6	24	1-22-024	3/8" SS FLAT WASHER

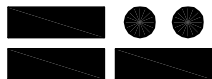

**DuMor, inc.**

P.O. Box 142 Mifflintown, PA 17059-0142

SCALE : NONE  
DATE DRAWN : 7/31/95  
DRAWN BY : AH  
DATE REV. : 10/25/11  
REV. BY : RDH

TITLE : BENCH ASSEMBLY

REV. D

DRAWING NUMBER

88 SERIES PL

SHEET 2 OF 2