

**NOTES**

- 1.) ALL STL. MEMBERS COATED W/ ZINC RICH EPOXY THEN FINISHED W/ POLYESTER POWDER COATING.
- 2.) 1/2" X 3 3/4" EXPANSION ANCHOR BOLTS PROVIDED.

**SLAT OPTIONS**

- "CEDAR" RECYCLED PLASTIC
- "GREY" RECYCLED PLASTIC
- "REDWOOD" RECYCLED PLASTIC
- "WALNUT" RECYCLED PLASTIC
- OTHER \_\_\_\_\_

PARTS LIST

ITEM	QTY	PART NO	DESCRIPTION
1	3	0-143-60PL-01	2" X 3" X 71" INT'R SLAT, PLASTIC
2	4	0-460-00-02	CONTOUR STRAP
3	2	0-460-60-03	71 3/4" ALUM EXTRUSION
4	1	0-461-00L-01	LEFT BKLS BENCH SUPPORT
5	1	0-461-00R-01	RIGHT BKLS BENCH SUPPORT
6	4	1-12-053	5/16" X 1 1/2" SS BTN SKT HD CAP SCR
7	12	1-13-023	5/16" X 1 1/2" SS BTN SKT HD LAG
8	12	1-22-017	5/16" SS FLAT WASHER

KITS PROVIDED

ITEM	QTY	PART NO	DESCRIPTION
9	1	K-ANCO860-4	1/2" X 3 3/4" SS ANCHOR KIT (4PC)
10	1	K-BC0524-4	5/16" CAP HARDWARE KIT (4PC)
11	1	K-BL0524-12	5/16" LAG HARDWARE KIT (12PC)

NOTES:

- 1.) DURING ASSEMBLY PROCEDURE;  
DO NOT COMPLETELY TIGHTEN HARDWARE.
- 2.) THE ACTUAL PARTS WILL NOT BE NUMBERED.  
NUMBERS ONLY APPLY TO DRAWING.
- 3.) UPON COMPLETION OF ASSEMBLY SQUARE  
ALL COMPONENTS THEN TIGHTEN ALL HARDWARE.
- 4.) MOUNT AND ANCHOR AS SPECIFIED.

TOOLS REQ'D

- 3/4" WRENCH  
1/4" ALLEN WRENCH  
3/16" ALLEN WRENCH  
1/2" MASONRY DRILL BIT  
DRILL

① ATTACH SLATS TO CONTOUR STRAPS.

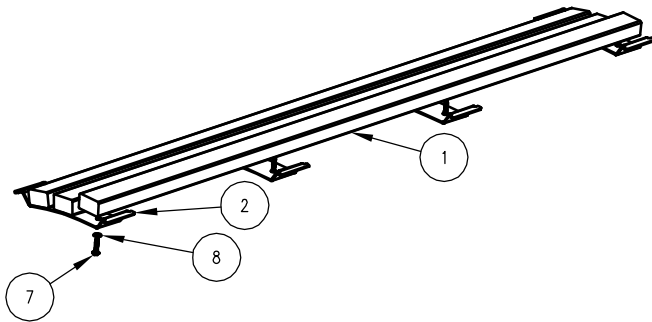

② ATTACH ALUM. EXTRUSION AS SHOWN, TO LEFT & RIGHT BENCH SUPPORTS, ENSURE PINS ARE IN "L" SLOTS.

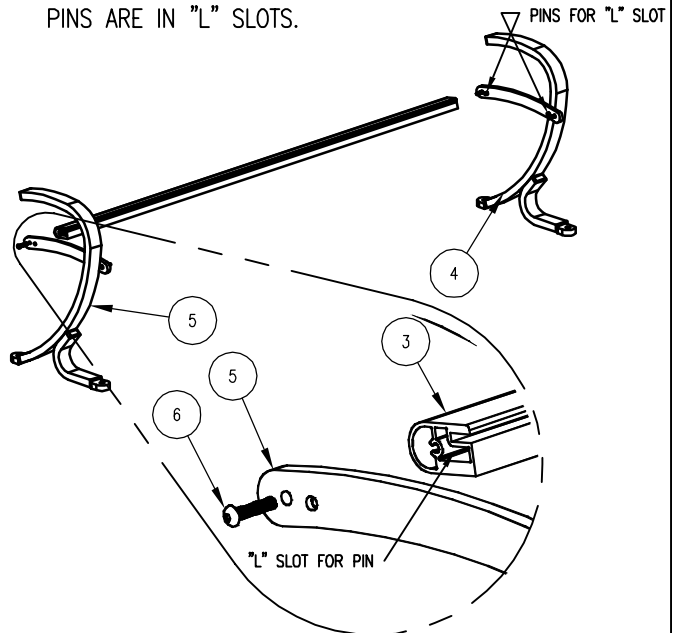

③ INSERT STEP 1 INTO STEP 2, USING SLOT ON ALUM. EXTRUSION.  
\*NOTE: RIGHT BENCH SUPPORT NOT SHOWN FOR CLARITY.\*

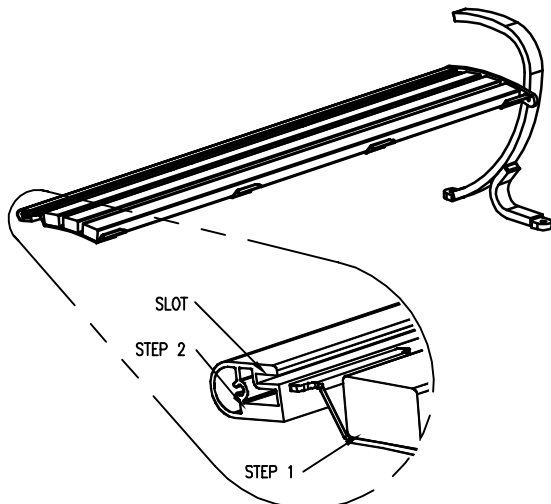

④ ATTACH REMAINING ALUM. EXTRUSION TO SUPPORTS, AS IN STEP 2.

