

S-2 SURFACE

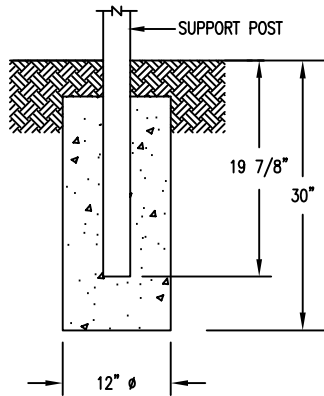

S-1 EMBEDMENT

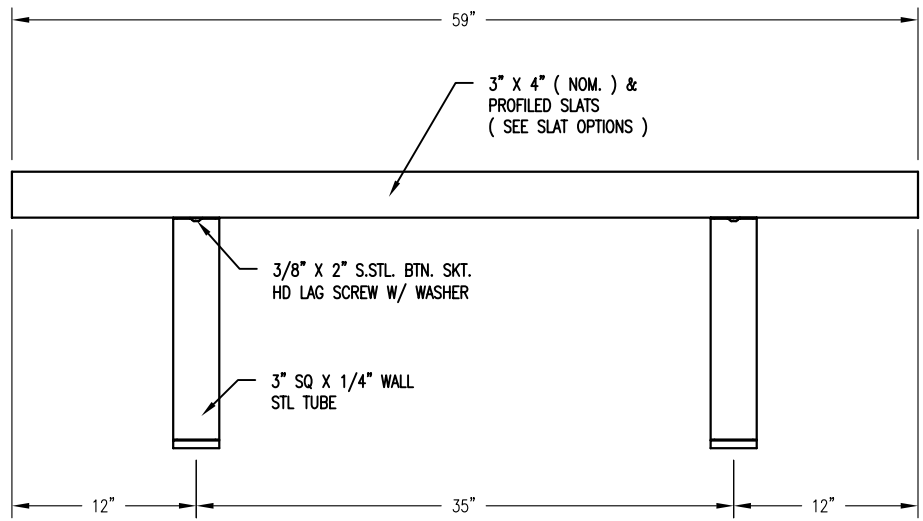
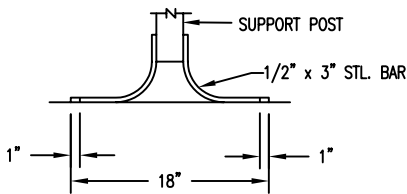
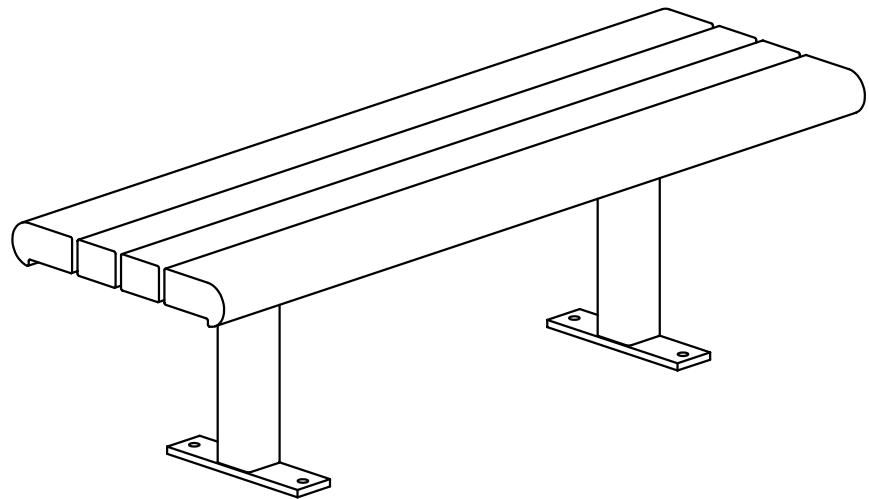

S-3 GULL WING

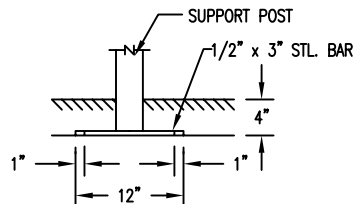

S-4 SUB FLOOR

SLAT OPTIONS

- "CEDAR" RECYCLED PLASTIC
- "GREY" RECYCLED PLASTIC
- "REDWOOD" RECYCLED PLASTIC
- "WALNUT" RECYCLED PLASTIC
- OTHER \_\_\_\_\_

NOTES

- 1.) ALL STL. MEMBERS COATED W/ ZINC RICH EPOXY THEN FINISHED W/ POLYESTER POWDER COATING.
- 2.) 1/2" x 3 3/4" EXPANSION ANCHOR BOLT PROVIDED FOR S-2, S-3 & S-4 OPTIONS.

  
**DuMor, inc.**  
 P.O. Box 142 Mifflintown, PA 17059-0142

SCALE : NONE  
 DATE DRAWN : 10/1/98  
 DRAWN BY : HD  
 DATE REV. : 10/26/11  
 REV. BY : JSB

TITLE : BENCH

REV. G

DRAWING NUMBER

103-50PL

SHEET 1 OF 2

SURFACE MOUNT  
OPTION SHOWN

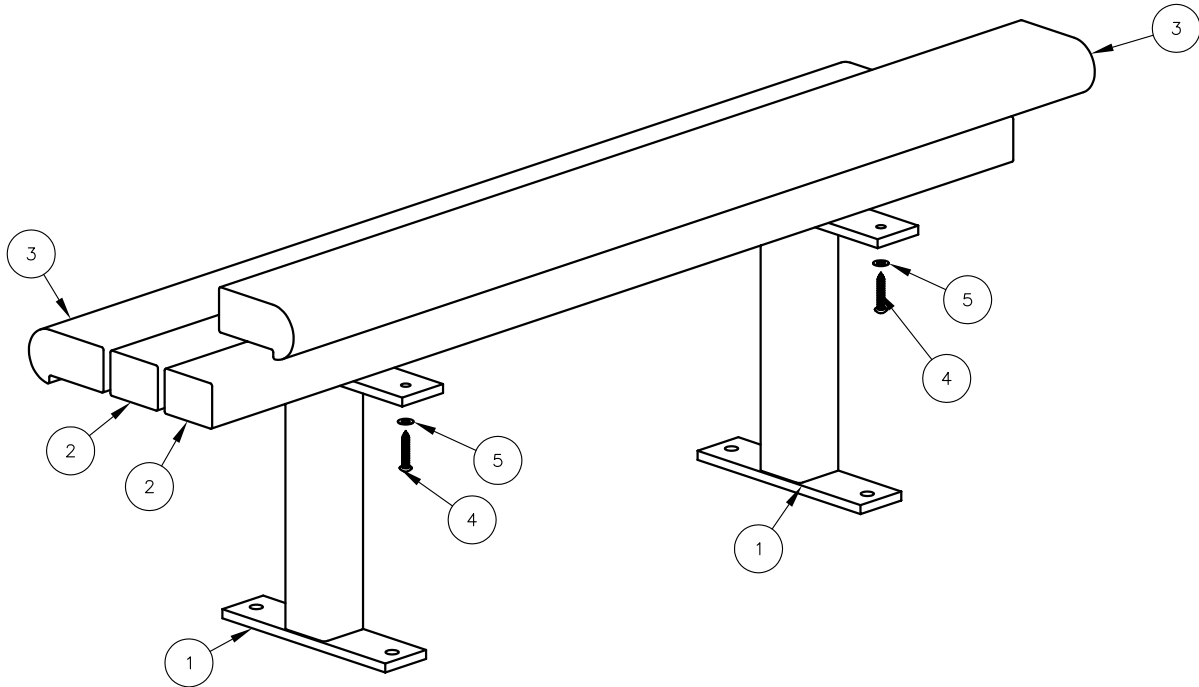

**NOTE:**

- 1.) DURING ASSEMBLY PROCEDURE;  
DO NOT COMPLETELY TIGHTEN HARDWARE.
- 2.) THE ACTUAL PARTS WILL NOT BE NUMBERED:  
NUMBERS ONLY APPLY TO DRAWING.
- 3.) SEE SPEC. SHEET 1 FOR MOUNTING OPTIONS.

**STEP 1:**

USE 3 - PCS. SUPPORT FOR SURFACE MOUNT ( 1 )  
 2 - PCS. 3" X 4" X 59" PLASTIC INT'R SLAT ( 2 )  
 2 - PCS. 59" PLASTIC EDGE SLAT ( 3 )  
 12 - PCS. 3/8" X 2" SS. BTN. SKT. HD. LAG SCR. ( 4 )  
 12 - PCS. 3/8" SS. FLAT WASHER ( 5 )  
 ATTACH SLATS ( 2 & 3 ) TO SUPPORT FOR SURFACE MOUNT  
 ( 1 ) USING HARDWARE ( 4 & 5 ). TIGHTEN TO SNUG FIT.  
 REPEAT UNTIL ALL SLATS ARE ATTACHED.

**STEP 2:**

UPON COMPLETION OF BENCH ASSEMBLY SQUARE ALL  
 COMPONENTS THEN TIGHTEN ALL HARDWARE.

**STEP 3:**

ANCHOR ACCORDING TO SUPPORT OPTION USED.

ITEM	QTY	PART NO	DESCRIPTION
1	2	0-103-00-01/S-2	SUPPORT FOR SURFACE MOUNT
2	2	0-88-50PL-02	3" X 4" X 59" PLASTIC SLAT
3	2	0-88-50PL-03	59" PLASTIC EDGE SLAT
4	8	1-13-016	3/8" X 2" SS BTN SKT HD LAG SCR
5	8	1-22-024	3/8" SS FLAT WASHER

**DuMor, inc.**  
 P.O. Box 142 Mifflintown, PA 17059-0142

SCALE : NONE  
 DATE DRAWN : 10/1/98  
 DRAWN BY : HD  
 DATE REV. : 4/12/10  
 REV. BY : AWH

TITLE : BENCH ASSEMBLY  
 REV. E  
 DRAWING NUMBER 103-50PL  
 SHEET 2 OF 2