

NOTES

- 1.) ALL STL. MEMBERS COATED W/ ZINC RICH EPOXY THEN FINISHED W/ POLYESTER POWDER COATING.
- 2.) 1/2" X 3 3/4" EXPANSION ANCHOR BOLTS PROVIDED.

WOOD OPTIONS

- 'C' & BTR. DOUGLAS FIR KD S4S EE
- IPE S4S EE
- OTHER _____



BENCH

DATE DRAWN : 10/03/13
 DRAWN BY : RDH
 DATE REV. : 12/31/15
 REV. BY : ESS

REV.
C

DRAWING
NUMBER

472-60/S-2

SHEET
1 OF 2

NOTES:

- 1.) DURING ASSEMBLY PROCEDURE;
DO NOT COMPLETELY TIGHTEN HARDWARE.
- 2.) THE ACTUAL PARTS WILL NOT BE NUMBERED.
NUMBERS ONLY APPLY TO DRAWING.
- 3.) UPON COMPLETION OF ASSEMBLY SQUARE
ALL COMPONENTS THEN TIGHTEN ALL HARDWARE.
- 4.) MOUNT AND ANCHOR AS SPECIFIED.

TOOLS REQ'D

- 3/16" ALLEN WRENCH
- 1/4" ALLEN WRENCH
- 1/2" WRENCH
- 3/4" WRENCH
- 9/16" WRENCH
- 1/2" MASONRY DRILL BIT
- DRILL

PARTS LIST

ITEM	QTY	PART NO	DESCRIPTION
1	2	0-470-00-01	STL SUPPORT
2	1	0-472-60-03	71" INT'R SLAT, WOOD
3	1	0-472-60-04	71" INT'R SLAT, WOOD
4	4	0-472-60-05	2" X 6" X 71" EDGE PROFILE SLAT, WOOD
5	1	0-472-60-07	STL SEAT FRAME
6	1	0-472-60-08	STL BACKREST FRAME
7	4	1-11-003	3/8" X 1 1/2" SS CGE BOLT
8	4	1-12-133	3/8" X 3/4" SS BTN SKT HD CAP SCR
9	14	1-13-023	5/16" X 1 1/2" SS BTN SKT HD LAG
10	4	1-13-038	5/16" X 2" SS HEX HD LAG SCR
11	4	1-20-007	3/8" SS NYLON LOCKNUT
12	18	1-22-017	5/16" SS FLAT WASHER
13	4	1-22-024	3/8" SS FLAT WASHER

KITS PROVIDED

ITEM	QTY	PART NO	DESCRIPTION
14	1	K-ANC0860-4	1/2" X 3 3/4" SS ANCHOR KIT (4PC)
15	1	K-BC0612-4	3/8" CAP HARDWARE KIT (4PC)
16	1	K-BL0524-14	5/16" LAG HARDWARE KIT (14PC)
17	2	K-CG0624-2L	3/8" CGE BOLT HARDWARE KIT W/ LOCK NUTS (2PC)
18	2	K-HL0532-2	5/16" LAG HARDWARE KIT (2PC)

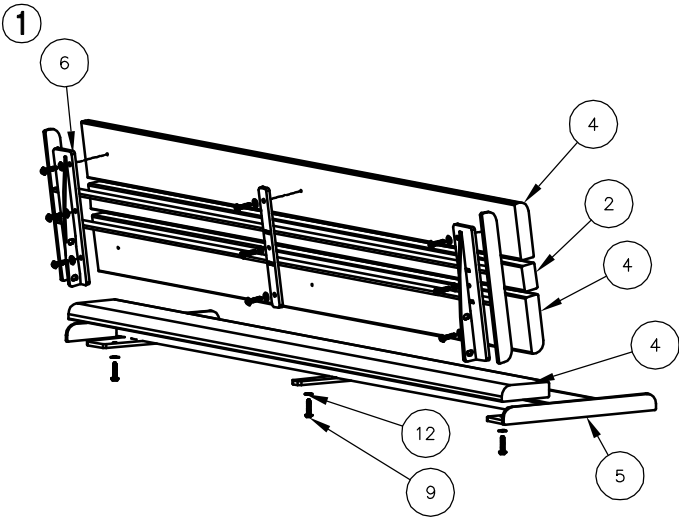

ATTACH REAR SEAT SLAT ONLY TO SEAT FRAME.
DO NOT ATTACH FRONT TWO SLATS OF SEAT.
ATTACH SLATS TO BACKREST FRAME.

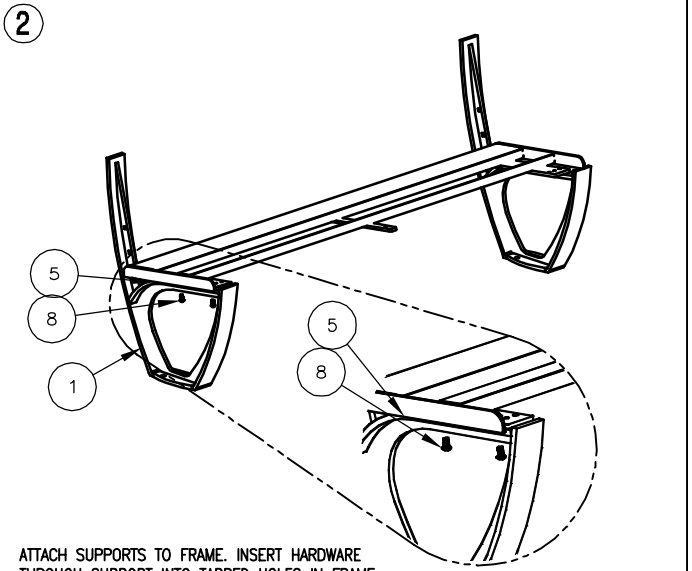

ATTACH SUPPORTS TO FRAME. INSERT HARDWARE
THROUGH SUPPORT INTO TAPPED HOLES IN FRAME.

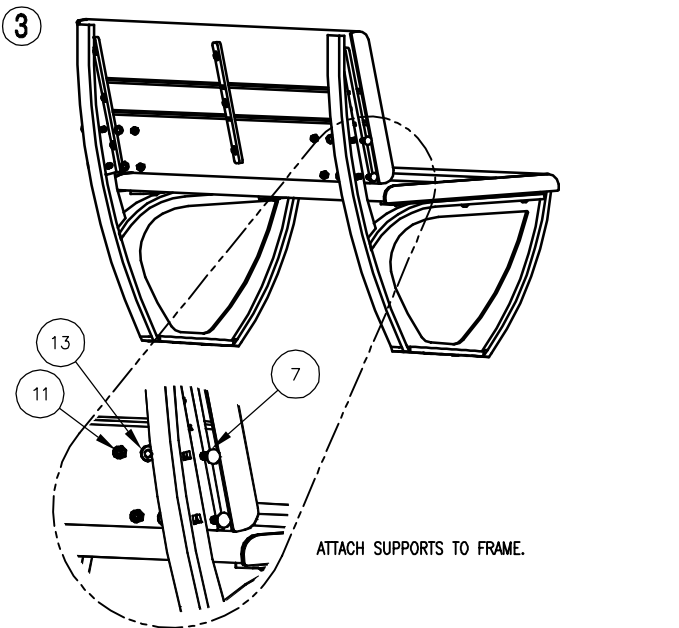

ATTACH SUPPORTS TO FRAME.

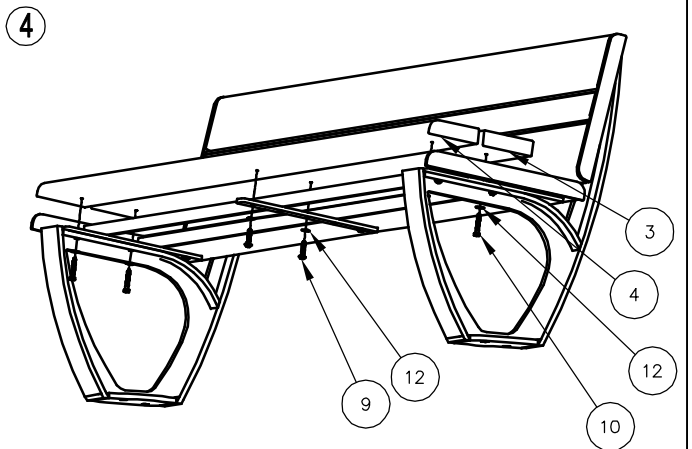

ATTACH FRONT TWO REMAINING SEAT SLATS.



ASSEMBLY INSTRUCTIONS

DATE DRAWN : 10/03/13
DRAWN BY : RDH
DATE REV. : 12/31/15
REV. BY : ESS

REV.
C

DRAWING NUMBER

472-60/S-2

SHEET
2 OF 2